

# BULL 8M - BULL 8M.S BULL 8 OM - BULL 8 OM.S

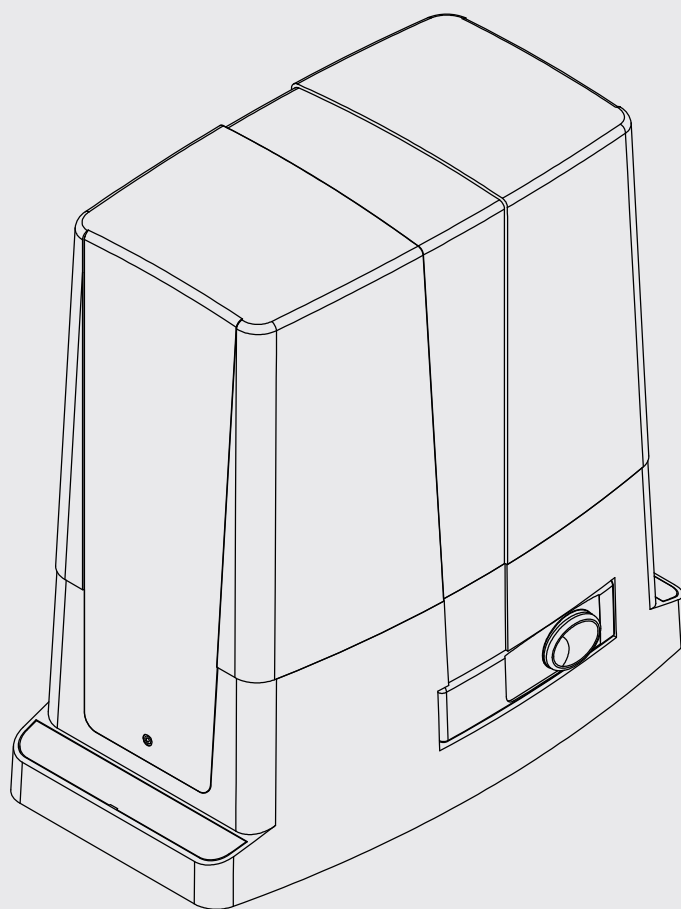

**BENINCA**<sup>®</sup>  
TECHNOLOGY TO OPEN



1

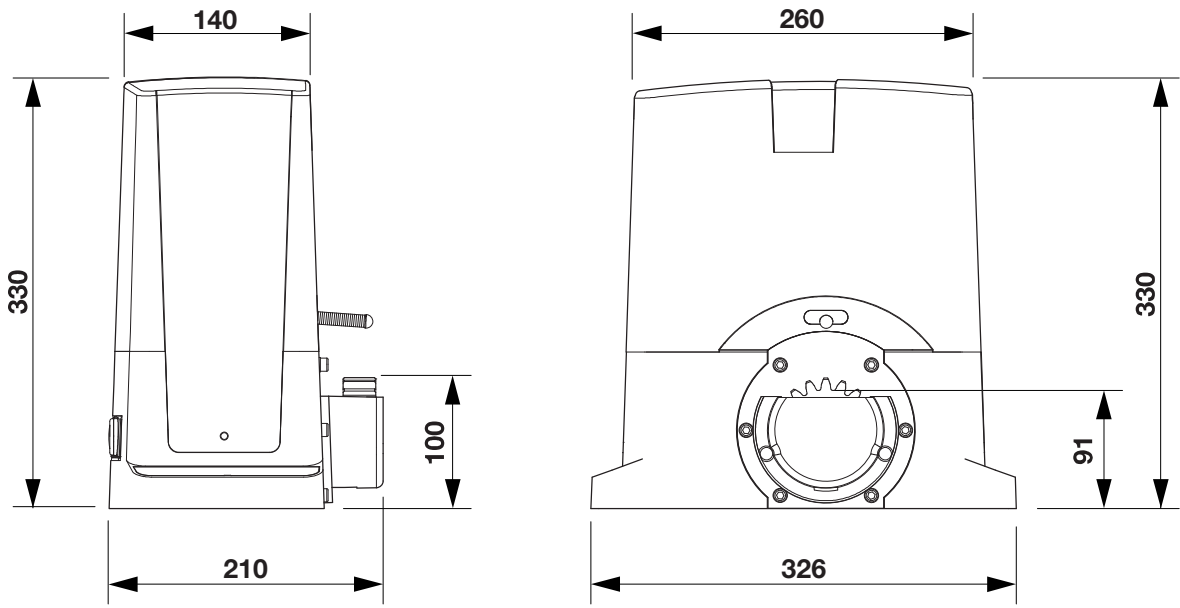

2

BULL.P3  
(Optional)

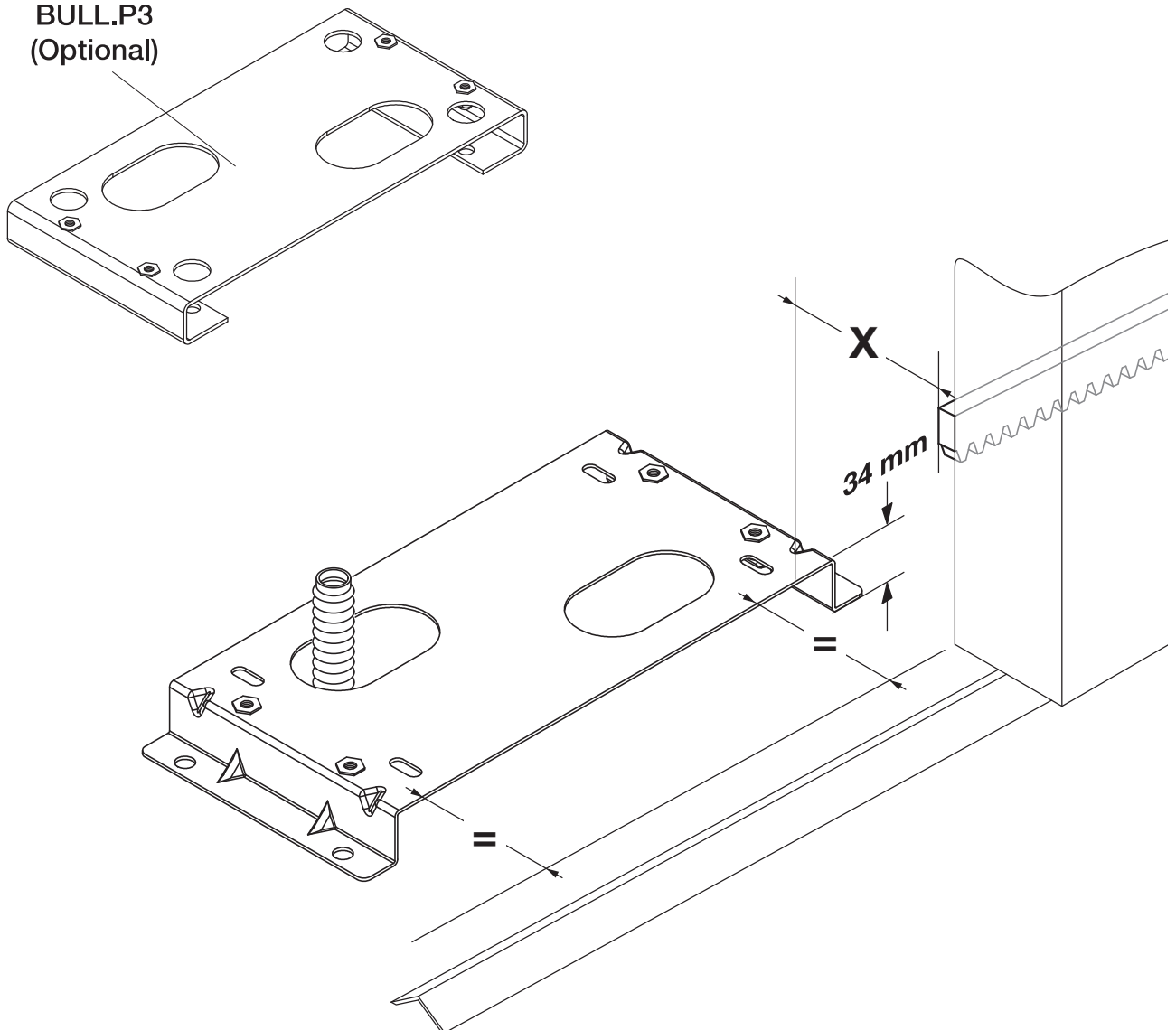

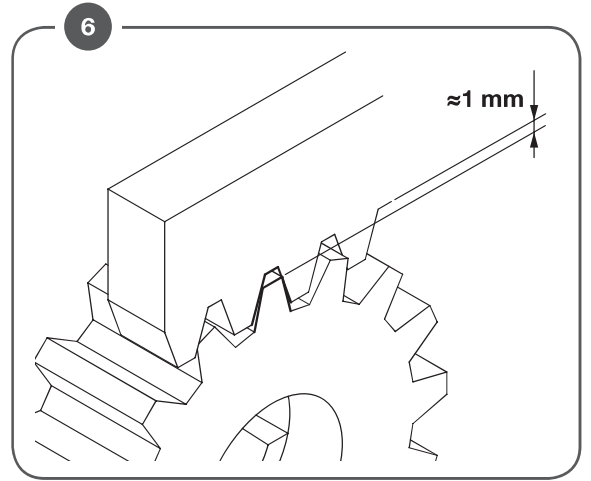
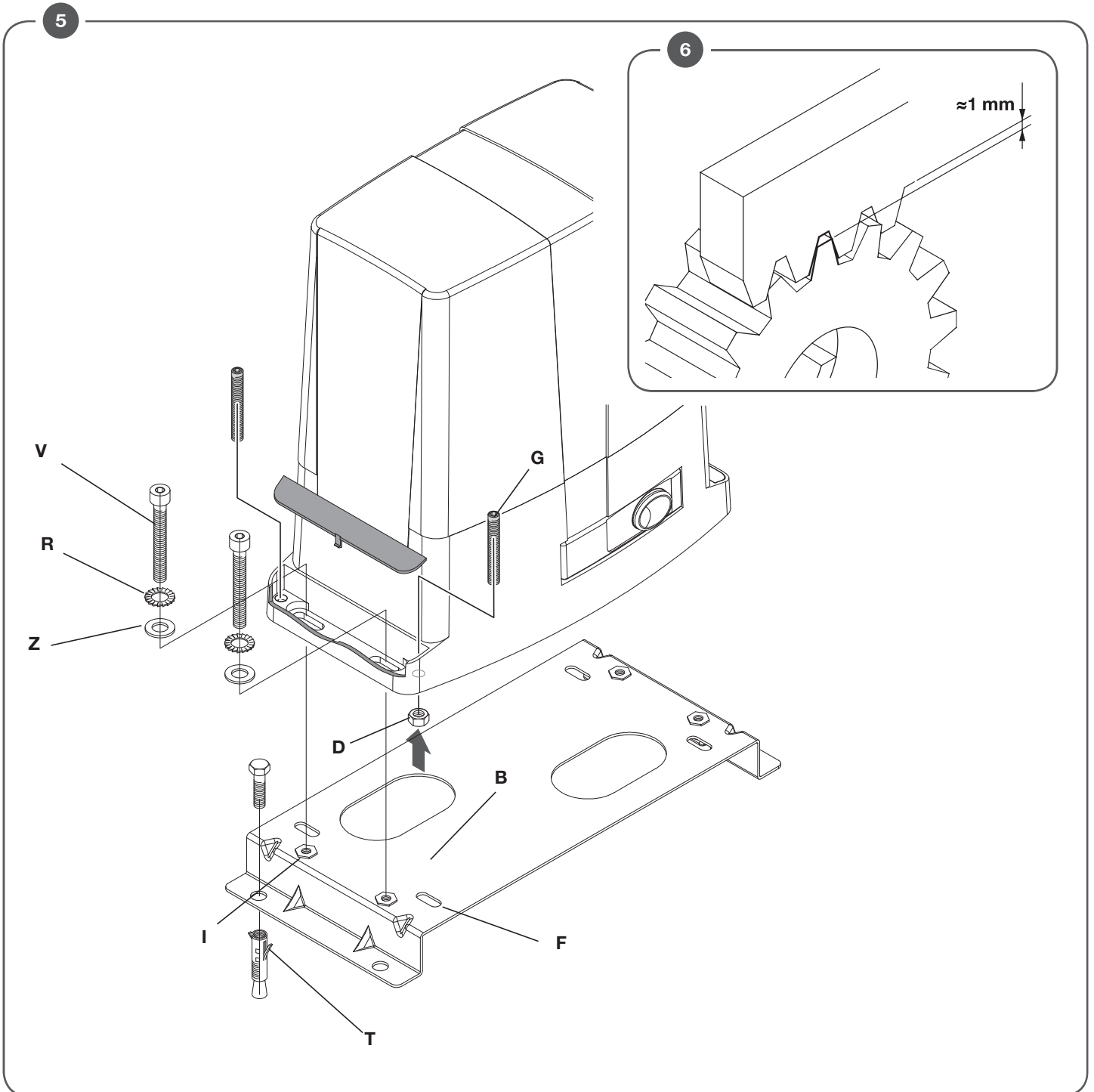
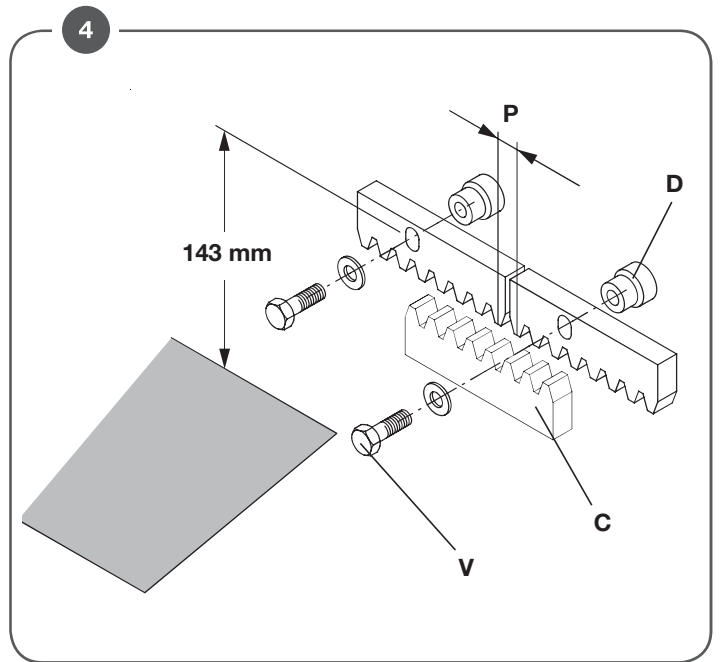
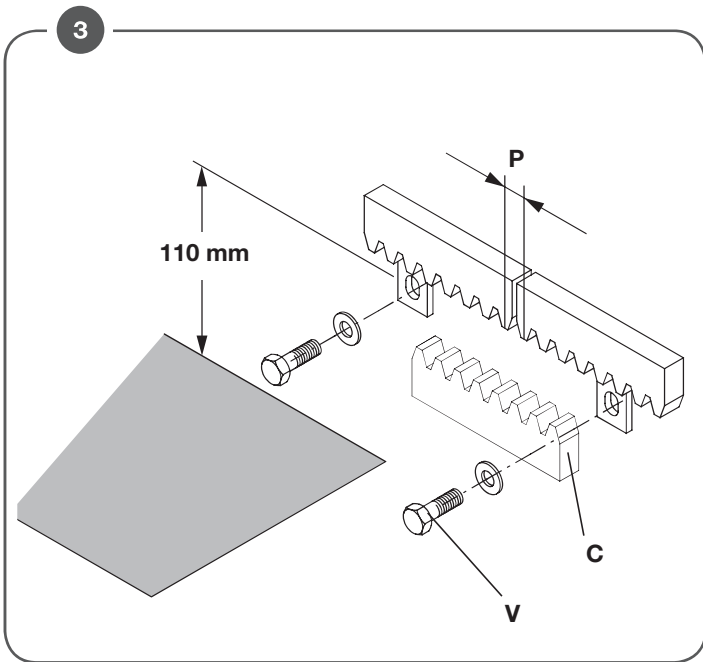

7

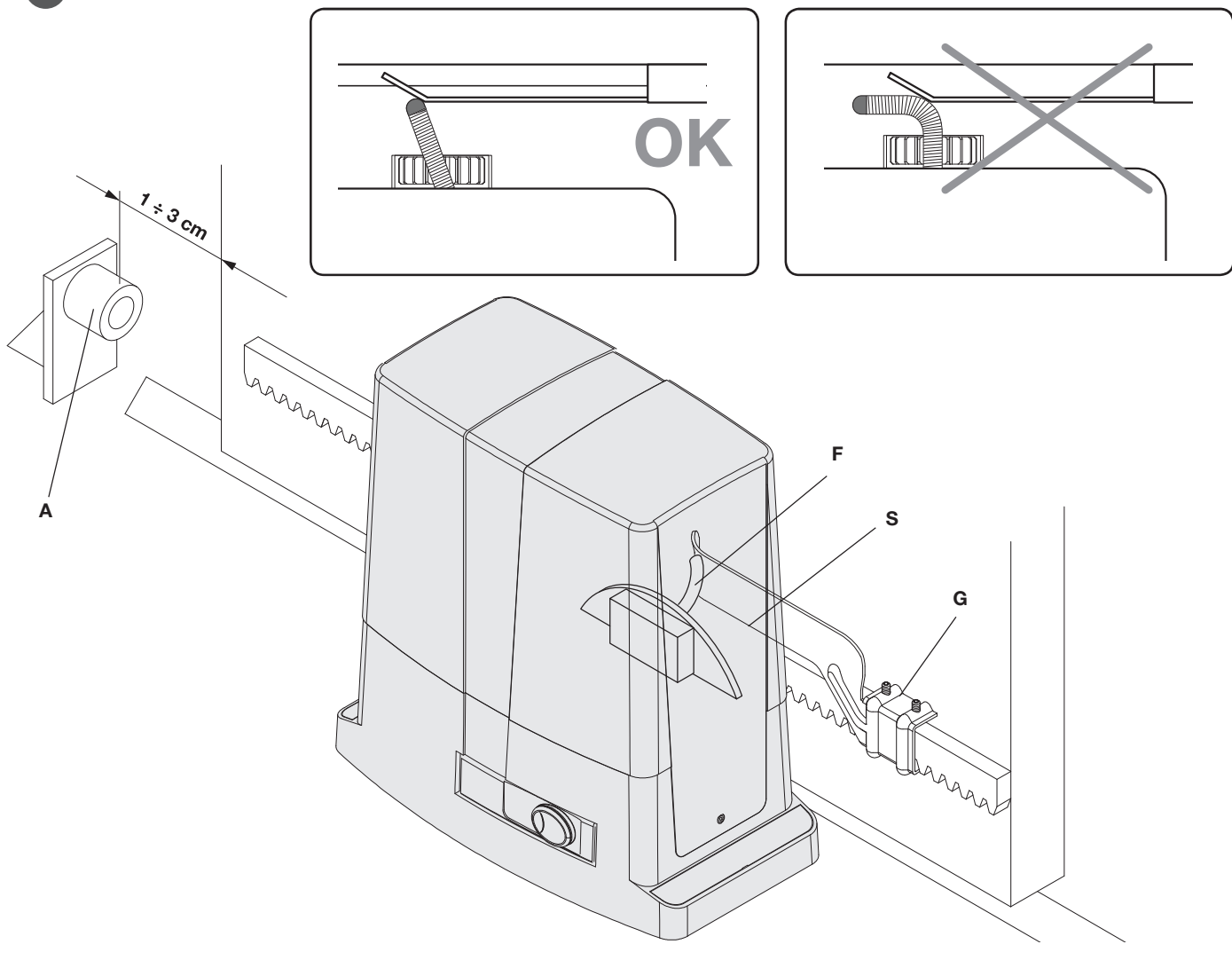

8

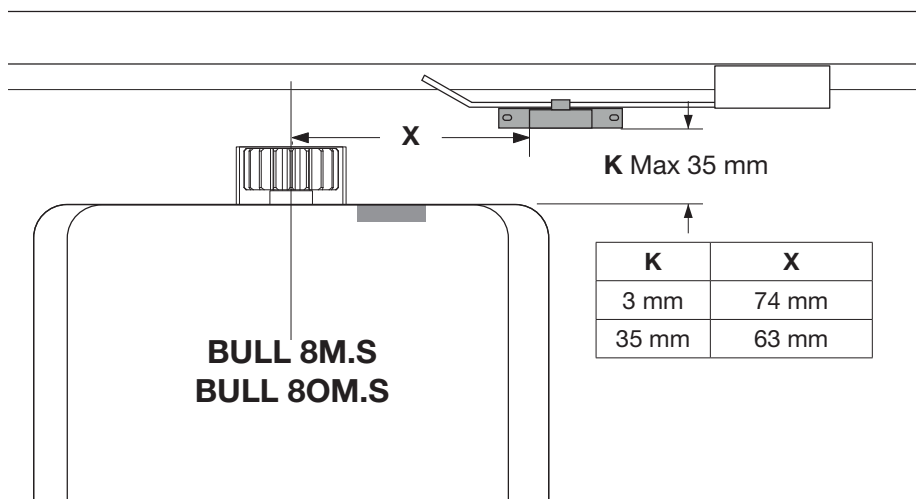
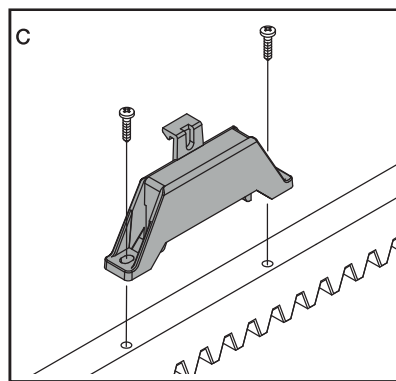
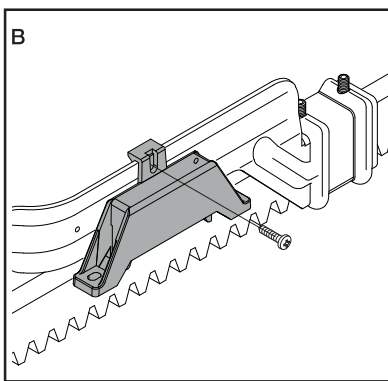
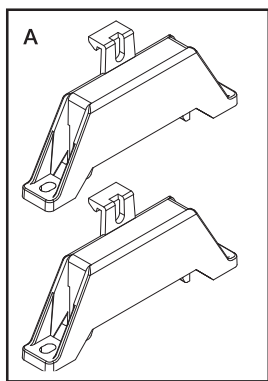

**BULL 8M.S**  
**BULL 80M.S**

K	X
3 mm	74 mm
35 mm	63 mm

9

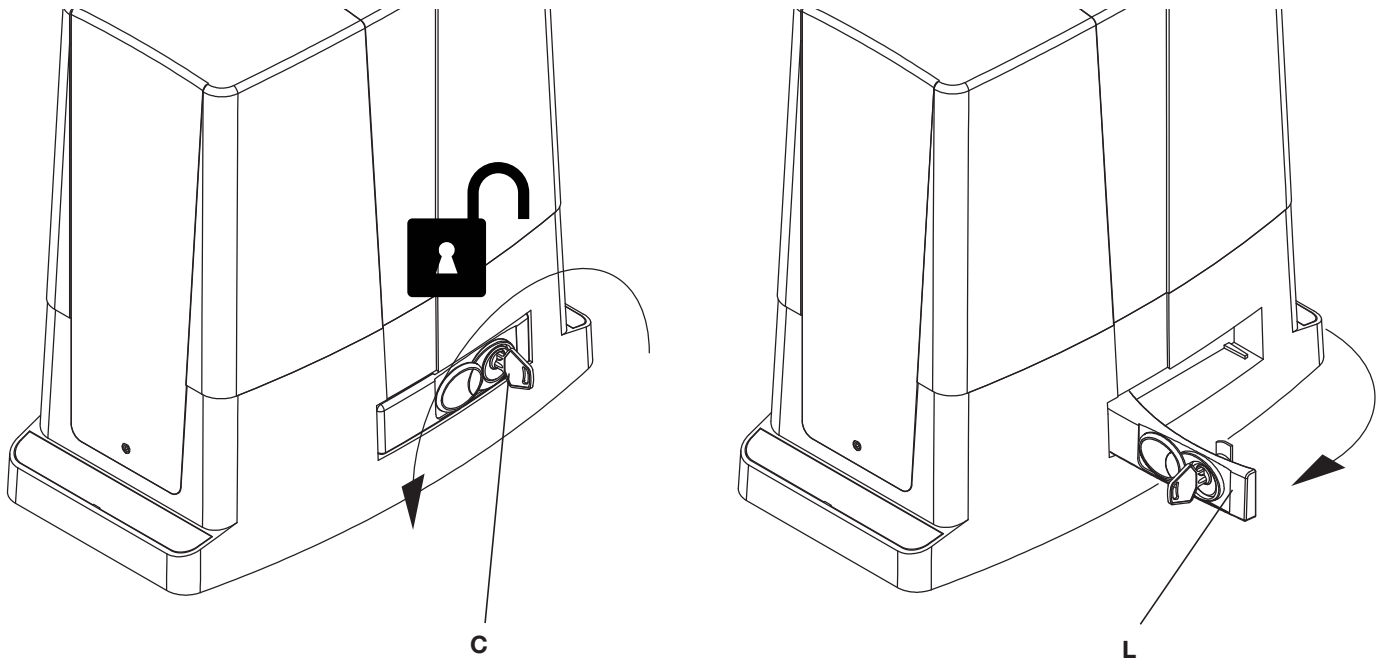

10

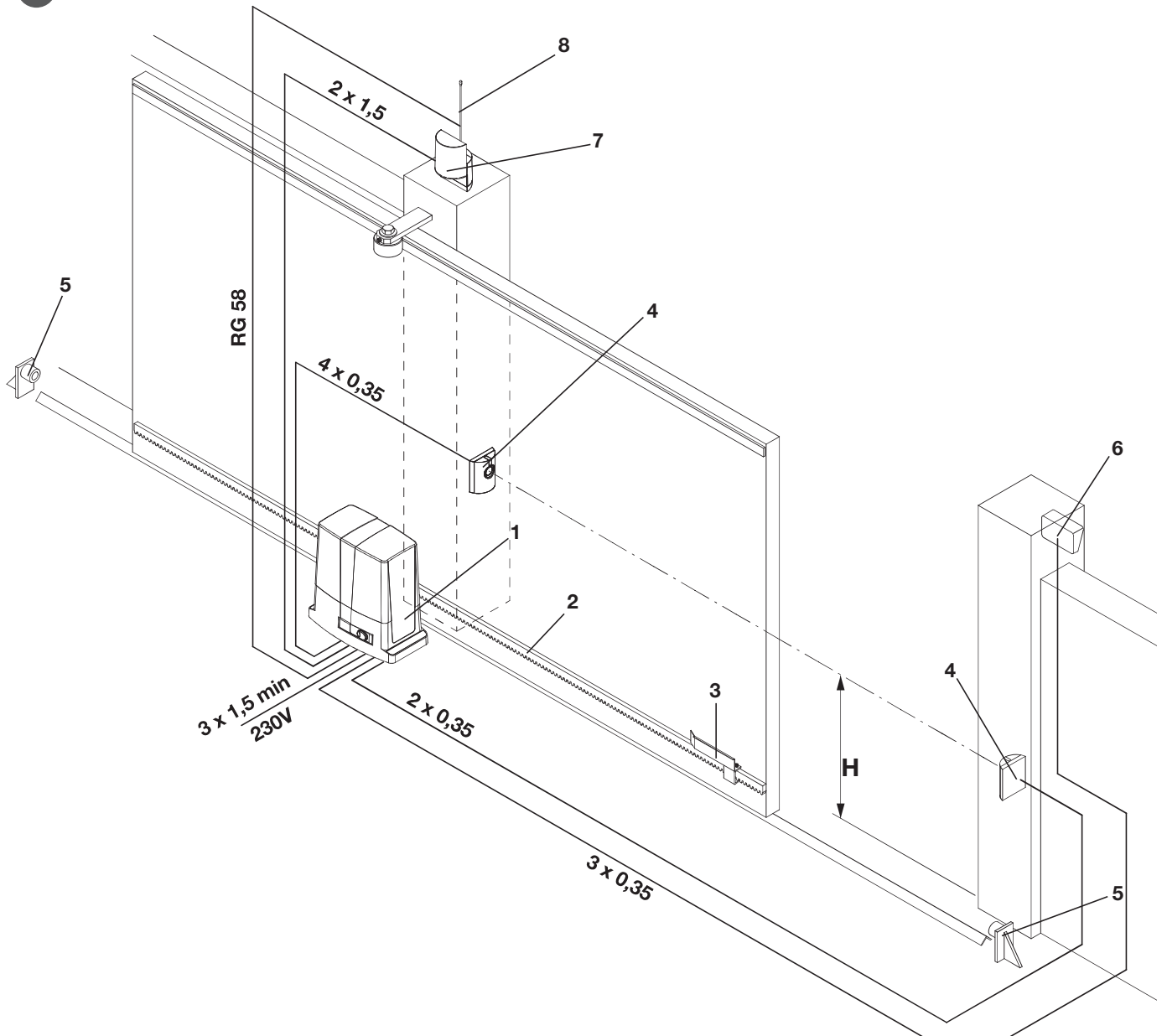

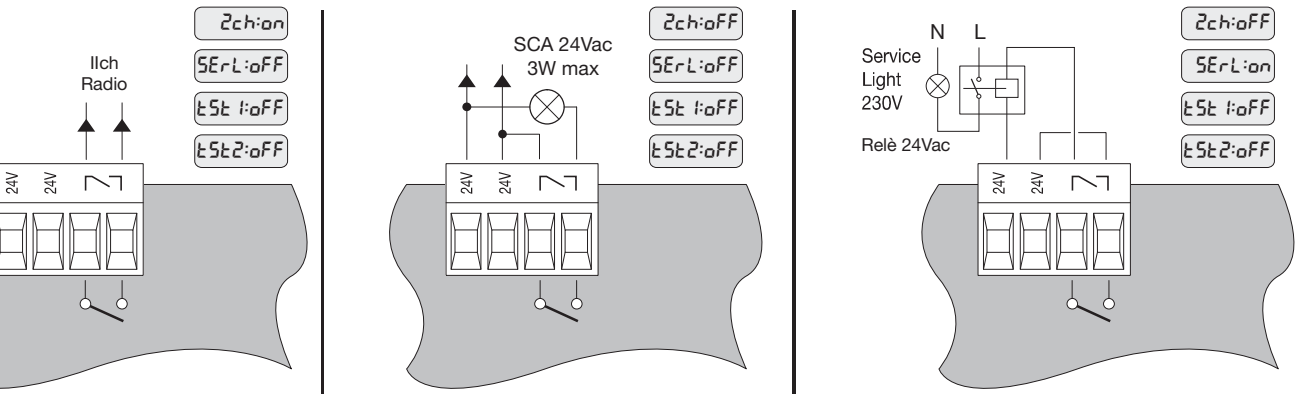
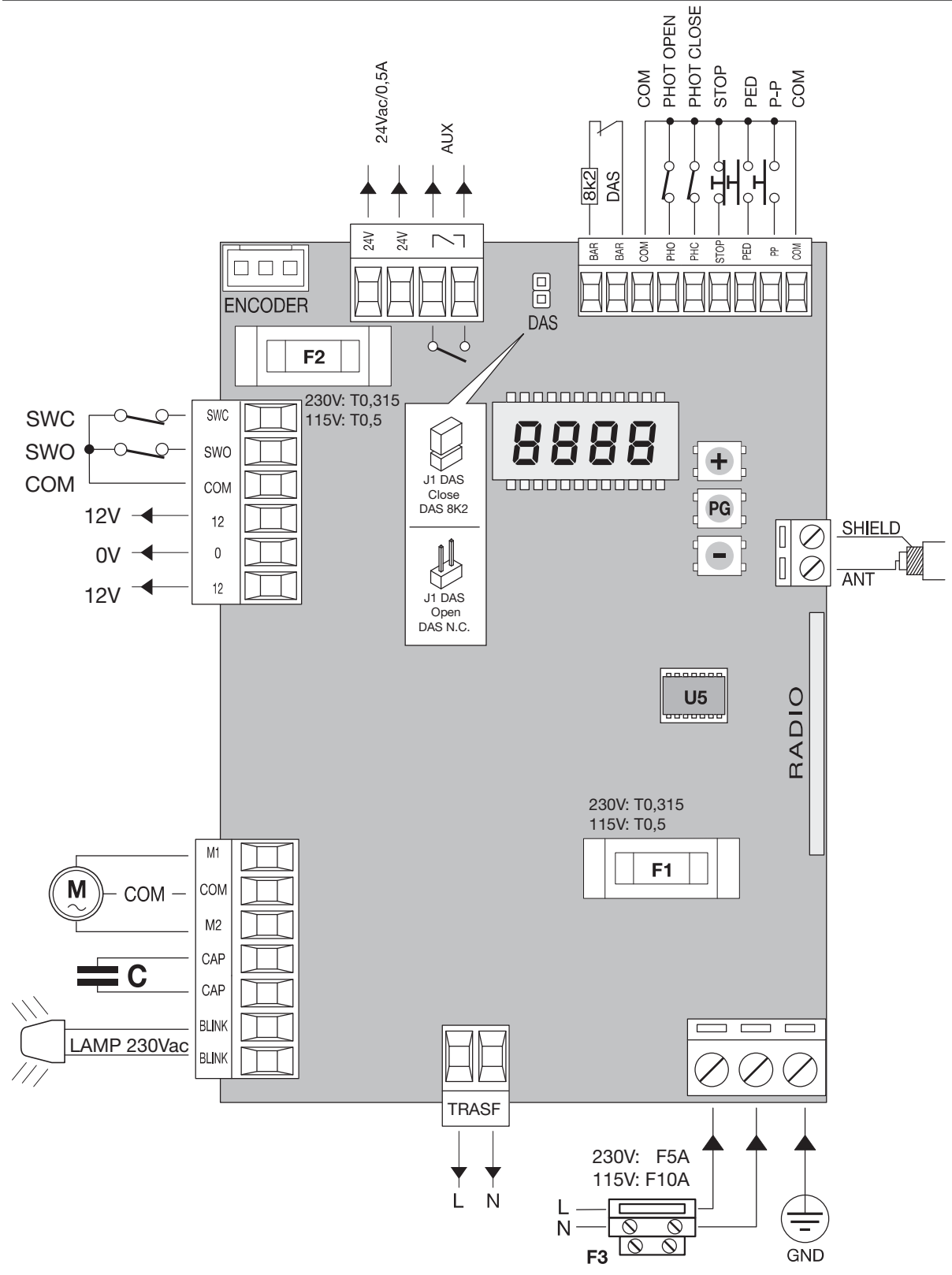

13

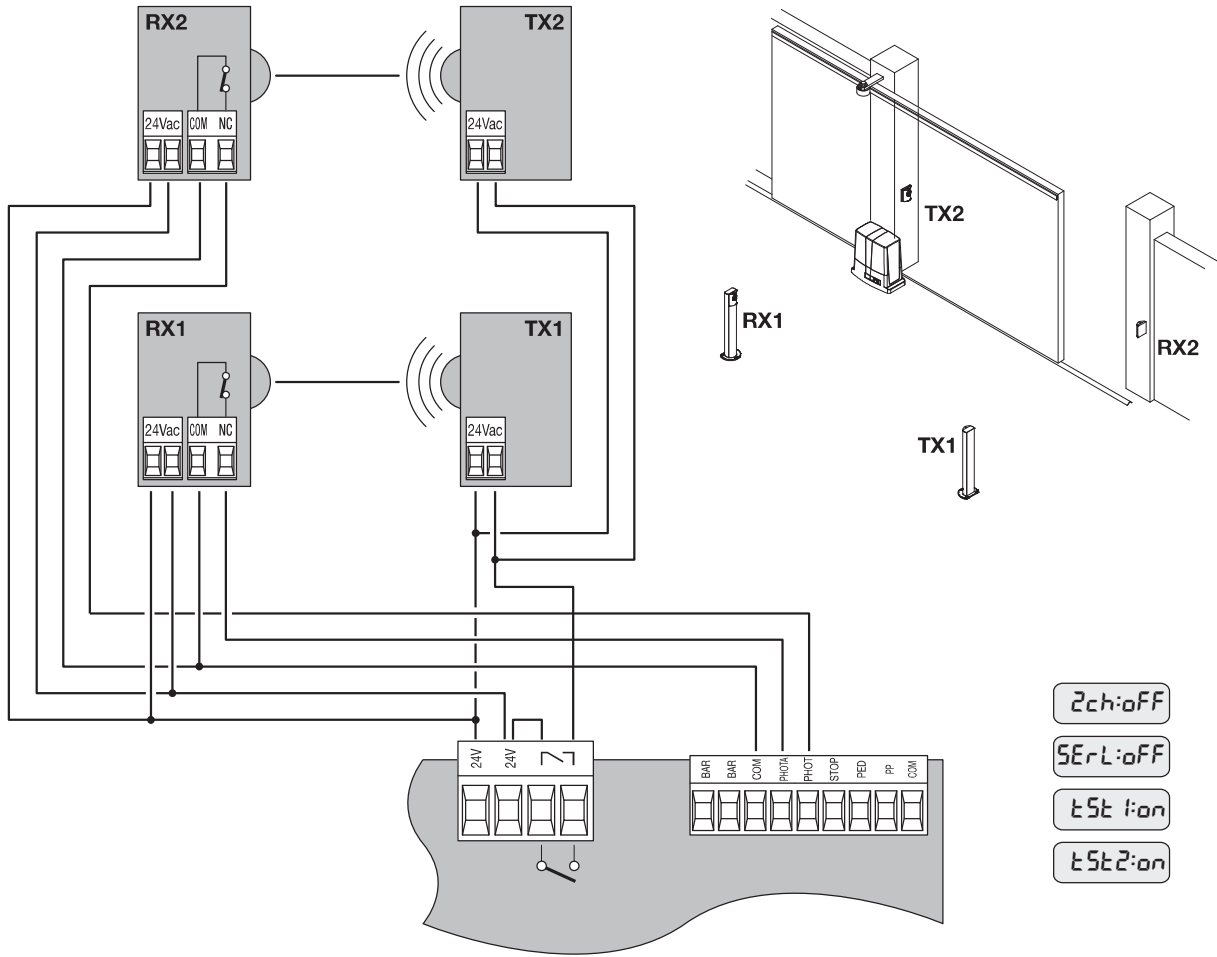

14

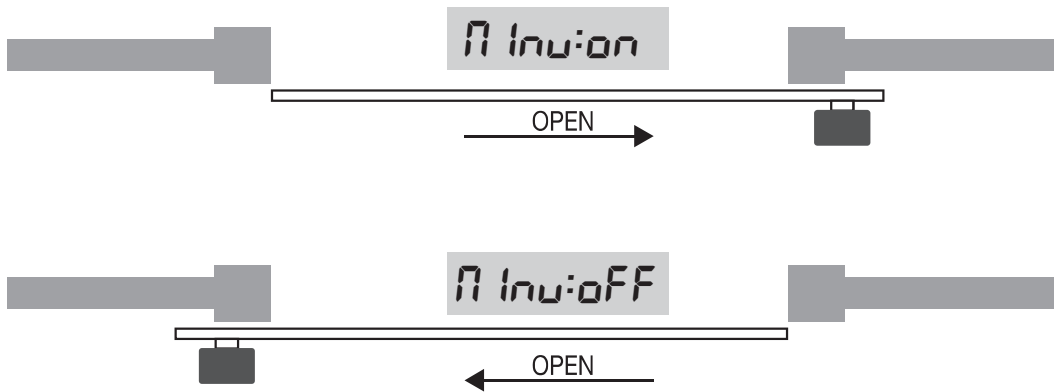

15

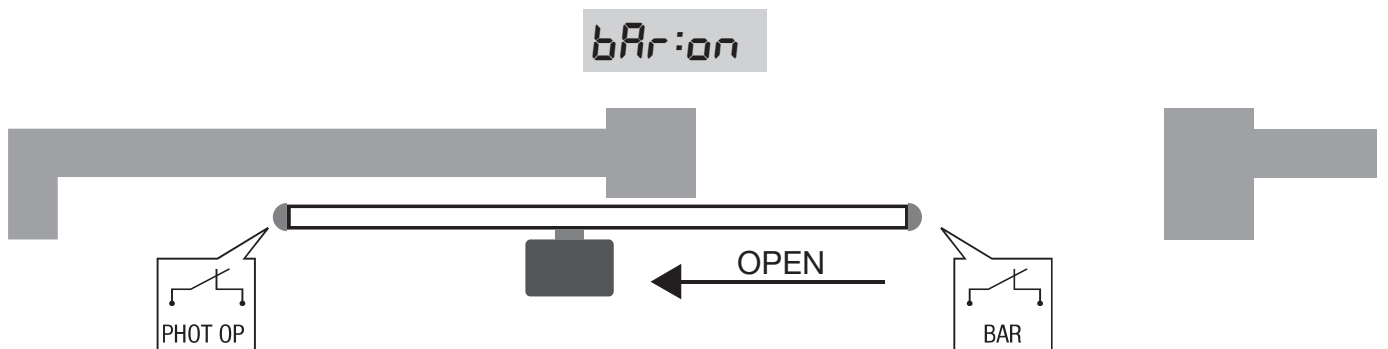

# INDEX

1) INTRODUCTION .....	17	12.2) FUSES .....	19
2) GENERAL INFORMATION .....	17	12.3) TO CHECK CONNECTIONS .....	20
3) TECHNICAL DATA .....	17	13) STROKE LEARNING .....	20
4) PRELIMINARY CHECKS .....	17	14) ARC COMPATIBLE CONTROL UNIT .....	20
5) INSTALLATION (FIG.1).....	17	15) OPERATING MODE WITH ENABLED/DISABLED ENCODER .....	20
6) FITTING OF THE RACK (FIG.3-4).....	17	16) PROGRAMMING .....	20
6.1) RACK IN NYLON (FIG.3).....	17	16.1) USE OF PROGRAMMING KEYS .....	20
6.2) RACK IN FE 12X30MM (FIG.4).....	17	17) PARAMETERS, LOGICS AND SPECIAL FUNCTIONS.....	21
7) POSITIONING OF THE FOUNDATION PLATE (FIG. 5-6) .....	17	17.1) PARAMETERS (PPr).....	21
7.1) FITTING WITH SCREW ANCHORS ON CEMENT BASE) .....	17	17.2) LOGIC (LoE).....	21
7.2) INSTALLATION WITH CEMENT .....	18	17.3) RADIO (rRd) .....	22
7.3) HEIGHT ADJUSTMENT OF THE GEARED MOTOR.....	18	17.4) CYCLES NUMBER (nRn).....	23
8) POSITIONING OF THE LIMIT SWITCH BRACKETS (FIG.7) .....	18	17.5) MAINTENANCE CYCLES (RRC i).....	23
9) HOW TO INSTALL THE MAGNETS (BULL 5M.S - BULL 50M.S) FIG.8.....	18	17.6) RESET (rE5).....	23
9.1) FITTING ONTO THE LIMIT SWITCH BRACKETS.....	18	17.7) AUTOSET (RUE).....	23
9.2) FITTING ONTO THE RACK .....	18	17.8) PROTECTION CODE (codE) .....	23
10) MANUAL OPERATION (FIG.9) .....	18	18) DIAGNOSTICS .....	23
11) WIRE DIAGRAM (FIG.10) .....	18	19) REMOTE COPY OF TRANSMITTER CODES.....	23
12) CP.BULL8 OM CONTROL UNIT .....	19	20) ERROR MESSAGES .....	23
12.1) WIRE DIAGRAM .....	19		

## ENG

## WARNING



### GENERAL INFORMATIONS

The product shall not be used for purposes or in ways other than those for which the product is intended for and as described in this manual. Incorrect uses can damage the product and cause injuries and damages. The company shall not be deemed responsible for the non-compliance with a good manufacture technique of gates as well as for any deformation, which might occur during use. Keep this manual for further use.



### INSTALLER GUIDE

This manual has been especially written to be use by qualified fitters. Installation must be carried out by qualified personnel (professional installer, according to EN 12635), in compliance with Good Practice and current code. Make sure that the structure of the gate is suitable for automation. The installer must supply all information on the automatic, manual and emergency operation of the automatic system and supply the end user with instructions for use.



### GENERAL WARNINGS

Packaging must be kept out of reach of children, as it can be hazardous. For disposal, packaging must be divided the various types of waste (e.g. carton board, polystyrene) in compliance with regulations in force. Do not allow children to play with the fixed control devices of the product. Keep the remote controls out of reach of children. This product is not to be used by persons (including children) with reduced physical, sensory or mental capacity, or who are unfamiliar with such equipment, unless under the supervision of or following training by persons responsible for their safety. Apply all safety devices (photocells, safety edges, etc.) required to keep the area free of impact, crushing, dragging and shearing hazard. Bear in mind the standards and directives in force, Good Practice criteria, intended use, the installation environment, the operating logic of the system and forces generated by the automated system. Installation must be carried out using safety devices and controls that meet standards EN 12978 and EN 12453. Only use original accessories and spare parts, use of non-original spare parts will cause the warranty planned to cover the products to become null and void. All the mechanical and electrical parts composing automation must meet the requirements of the standards in force and outlined by CE marking.



### ELECTRICAL SAFETY

An omnipolar switch/section switch with remote contact opening equal to, or higher than 3mm must be provided on the power supply mains. Make sure that before wiring an adequate differential switch and an overcurrent protection is provided. Pursuant to safety regulations in force, some types of installation require that the gate connection be earthed. During installation, maintenance and repair, cut off power supply before accessing to live parts. Also disconnect buffer batteries, if any are connected. The electrical installation and the operating logic must comply with the regulations in force. The leads fed with different voltages must be physically separate, or they must be suitably insulated with additional insulation of at least 1 mm. The leads must be secured with an additional fixture near the terminals. During installation, maintenance and repair, interrupt the power supply before opening the lid to access the electrical parts. Check all the connections again before switching on the power. The unused N.C. inputs must be bridged.



### WASTE DISPOSAL

As indicated by the symbol shown, it is forbidden to dispose this product as normal urban waste as some parts might be harmful for environment and human health, if they are disposed of incorrectly. Therefore, the device should be disposed in special collection platforms or given back to the reseller if a new and similar device is purchased. An incorrect disposal of the device will result in fines applied to the user, as provided for by regulations in force.

*Descriptions and figures in this manual are not binding. While leaving the essential characteristics of the product unchanged, the manufacturer reserves the right to modify the same under the technical, design or commercial point of view without necessarily update this manual.*



## 1) INTRODUCTION

Congratulations on your choice of a BULL gear motor.

All items included in Benincà's wide product range stem from twenty year of our experience in the sector of automatic systems, always striving to find new materials and advanced technologies.

For this reason, nowadays we are able to offer you extremely reliable products that, thanks to their power, efficiency and long-lasting features, entirely meet the end user's requirements.

All our products are covered by a guarantee.

Furthermore, an R.C. insurance policy signed with a primary insurance company, covers any injuries or damages caused by manufacturing faults.

## 2) GENERAL INFORMATION

This automatic system, with 230Vac single-phase power supply for sliding gates, is available in the following versions:

BULL 5M/OM

BULL 5M.S/OM.S

for gates with maximum weight equal to 500kg

BULL is a monobloc system featuring a refined design and reduced dimensions. The motor and an irreversible reduction system, manufactured with high resistant materials, are housed in an aluminium container. BULL is equipped with spring limit switches. The customised key emergency release allows to open and close the gate in case of power failure.

Anti-crash safety is ensured by an electronic device (encoder and amperometric sensor) which detects any obstacle present.

## 3) TECHNICAL DATA

	BULL 5M	BULL 50M
Power supply	230Vac 50Hz	
Current drawn	1,3 A	
Torque	23,5 Nm	
Work jogging	30%	
Protection level	IP44	
Operating temperature	-20°C / +50°C	
Capacitor	12,5 µF	
Gate max. weight	500kg	
Rack module	M4	
Opening speed	10,5 m/min	
Noise	<70 dB	
Radio receiver	built in 433,92 MHz configurable (rolling-code or programmable + rolling-code)	
N° Transmitters supported	64	
Lubrication	CASTROL LP2	AGIP BLASIA 100
Weight	10,6 kg	13,4 kg

## 4) PRELIMINARY CHECKS

For a good operation of the automatic system for sliding gates, the gate or door shall meet the following features:

- the track and relevant wheels must feature correct sizes and must undergo adequate maintenance (in order to avert excessive friction during the sliding of the gate).
- during operation, the door shall not excessively oscillate.
- a mechanical stopper (according to regulations in force) shall limit the opening and closing movements.

## 5) INSTALLATION (FIG.1)

Overall dimensions of the gear motor expressed in mm.

## 6) FITTING OF THE RACK (FIG.3-4)

### 6.1) RACK IN NYLON (FIG.3)

Position the rack at a height of 110 mm from the centre line of the fixing slot provided on the base on which the foundation plate will be fitted. At that height, drill a hole on the gate and provide for a M6 threading.

Keep to the P tooth pitch, even from a section of rack and another. To this purpose, it could be useful to join another section of rack (Part. C)

### 6.2) RACK IN FE 12X30MM (FIG.4)

Position the spacers D by welding them or fitting them with screws to the gate, at 143 mm height from the centre line of the fixing slot provided on the base on which the foundation plate will be fitted. Fix the rack.

Keep to the P tooth pitch, for all sections of the rack. To this purpose, it could be useful to connect another section of rack (Part. C)

Then fix the rack with V screws, taking care, once the actuator is installed, that 1-mm backlash is left between the rack and the tow wheel (seei Fig.6). To this purpose, use the slots on the rack.

## 7) POSITIONING OF THE FOUNDATION PLATE (FIG. 5-6)

It is very important to keep to dimension X shown in Fig.2. This value depends on the type of rack used:

X = 11 mm for rack in nylon

X = 13 mm for rack in iron, 12x30mm

Preset a corrugated tube (Fig.2 -A) for the passage of power supply cables and connection wires for the accessories.

Check that, at the end of the fitting, the foundation plate is perfectly parallel with respect to the wing.

### 7.1) FITTING WITH SCREW ANCHORS ON CEMENT BASE)

Through 4 "T" screw anchors in steel (not supplied), firmly anchor the foundation plate to ground by means of 4 bolts "B" (not supplied). Use the foundation plate as drilling template.

To facilitate the fitting of bolts, 4 holes are provided on the plate (ref. F).

Fix the geared motor to the plate by means of the 4 screws V (M10x70), with the relevant plain washers R and knurled washers, as indicated in the figure.

## 7.2) INSTALLATION WITH CEMENT

In this case, after providing for an adequate foundation hole, pour cement on the plate, taking care of the plate level. Check that the threaded inserts (I) for the fitting screws are clean and cement free.

Wait for the hardening of the cement.

Fix the geared motor to the plate by means of the 4 screws V (M10x70), with the relevant plain washers R and knurled washers, as indicated in the figure.

## 7.3) HEIGHT ADJUSTMENT OF THE GEARED MOTOR

The height of the geared motor (10mm max) can be adjusted in height, with respect to the foundation base, by 4 dowels G.

In this case, BEFORE fitting the geared motor to the plate, apply the 4 adjustment dowels G, by inserting the 4 nuts D in the special housings located at the bottom of the geared motor.

Then adjust the 4 dowels by lifting the geared motor at the desired height. Fix the motor by firmly tighten the 4 screws V4 (M10x70) and related flat washers R and knurled washers Z, as shown in the figure.

## 8) POSITIONING OF THE LIMIT SWITCH BRACKETS (FIG.7)

Manually open the gate and leave a clearance from 1 to 3cm according to the weight of the gate between the main door and the mechanical stopper A. Fix the bracket to the limit switch S by using the grains G, so that the limit switch microswitch F is pressed. The same operation should be repeated with gate in the closing phase.

N.B.: The limit switch bracket should be positioned so that the gate can be stopped without hitting the mechanical stopper.

## 9) HOW TO INSTALL THE MAGNETS (BULL 5M.S - BULL 50M.S) FIG.8

The magnets are housed in special supports (fig.8-"A"). These magnets are to be fitted to the limit switch brackets or the rack and cause the triggering of sensors when they approach them.

### 9.1) FITTING ONTO THE LIMIT SWITCH BRACKETS

The bases are complete with hooking tongue allowing the fitting of the magnets to the limit switch bracket supplied with the operator, as shown in Fig.8-B.

This type of fitting allows to rapidly adjust the position of magnets. After calculating the correct distance, fix the support in the correct position by means of a screw, so as to avert the moving of the bracket.

### 9.2) FITTING ONTO THE RACK

As an alternative, the supports can be fitted directly to the rack, by using the slots shown in Fig. 8-C. This fitting mode does not allow for subsequent regulations. It is therefore advised to make some trials with temporarily fitted supports before carrying out the final fitting.

**IMPORTANT:** The correct distance of the magnet with respect to the sensor depends on the installation characteristics. This space cannot be preset and must be adjusted on a trial basis.

The distances regarding the triggering of the sensor (value X) with respect to distance K of 3 and 35 mm, which are shown in Fig. 8 are only indicative.

In any case, distance K must not exceed 35 mm as a higher distance will not allow the triggering of the magnetic sensor.

## 10) MANUAL OPERATION (FIG.9)

Should a power failure or malfunction occurs, to manually operate the gate proceed as follows:

- After inserting the customised key C, turn it anti-clockwise and pull the lever L.
- The gear motor is unlocked and the gate can be moved by hand.
- To return to the normal operating mode, close the lever L again and manually activate the gate until it is geared.

## 11) WIRE DIAGRAM (FIG.10)

For the wire connections of the system and to adjust the operating modes, please refer to the Instruction Manual of the control unit.

**In particular, the anti-crash device (encoder) should be adjusted according to regulations in force.**

**Please remember that the device should be earthed by means of the appropriate terminal.**

Fig.10 shows wiring for a standard installation. Before proceeding to wiring, check that the type of cables used is consistent with those required for accessories.

Dimension H stands for the installation height of photocells. A clearance between 40 and 60 cm is advisable.

Key of components:

- 1 Gear motor with incorporated BULL control unit
- 2 M4 rack, Nylon/Fe
- 3 Limit switch brackets
- 4 Photocells
- 5 Mechanical stoppers
- 6 Key selector or digital keyboard
- 7 Flashing light
- 8 Antenna

### WARNING

The RC product insurance policy, which covers any injuries or damages to objects caused by manufacturing defects, requires the use of Benincà's original accessories.

## 12) CP.BULL8 OM CONTROL UNIT

### 12.1) WIRE DIAGRAM

Wire connections shown in Fig. 11 are described hereunder:

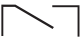
Terminals	Function	Description
L/N	Power supply	CP.BULL8 OM: Input, 230Vac 50Hz (L-Phase/N-Neutral) CP.BULL8 OM 115: Input, 115Vac 60Hz (L-Phase/N-Neutral)
GND	GND	Earth (compulsory)
ANT/SHIELD	Antenna	Connection antenna to the built-in receiver (ANT-signal/SHIELD-screen).
+12V	COMMON	Common for control inputs.
PP	Step-by-Step	Input, step-by-step push-button (N.O. contact) Pre-settable as Input, OPEN with OPCL logics. Contact usable for timed openings through timer.
PED	PEDESTRIAN	Input, pedestrian push-button (N.O. contact). It controls the partial opening, configurable through parameter TPED. At end of TCA time (if activated), closure control signal is sent. Pre-settable as Input, CLOSE with OPCL logics.
STOP	STOP	Input, STOP push-button (N.C. contact)
PHO/BAR O	PHOT O/BAR O	Input, (N.C. contact) for safety devices (e.g. photocells). During closure: if the contact is opened, the motor stops. With OPCL logics, when the photocell is no longer obscured, the motor reversion occurs (gate opens). During opening: if the contact is opened, the motor stops. with OPCL logics When the photocell is no longer obscured, the motor restarts opening. It can be modified in active edge input only when opening, bringing BAR=O-N logic. (see BAR logic).
PHA	PHOT C	Input, (N.C. contact) for safety devices (e.g. photocells). During closure: it can be preset by PHCL logics. During opening: it can be preset by PHCL logics.
+12V	COMMON	Common for control inputs.
BAR/BAR	SENSITIVE EDGE / SENSITIVE EDGE C	Input, sensitive edge contact Resistive edge: Jumper "DAS" closed Mechanical edge: Jumper "DAS" open If the edge is activated, the gate stops and a movement reversion occurs for about 3 sec. If the edge is not in use: Jumper "DAS" open, jumper between terminals BAR/BAR. It can be modified in active edge input only when closing, bringing the BAR=O-N logic. (see BAR logic).
	SCA Service light RX 2° Ch PHOTO TEST	Free, N.O. contact. Pre-settable as: - SCA (open gate indicator lamp): open contact when gate is closed, fast flashing light when gate is closing, slow flashing light when gate is opening and closed contact when gate is open. See wire diagram, Fig.12). (Logics 2CH:OFF, SERL:OFF, TST1:OFF, TST2:OFF); - Timed service light (see SERL logics and diagram in Fig.12); - Output, second radio channel (see 2CH logics and diagram in Fig.12); - PHOTO TEST to power the transmitters of photocells in TEST mode (see TST1, TST2 logics and diagram in Fig.13).
24Vac	24Vac	Output, power supply of accessories, 24Vac/500mA max
ENC1	ENCODER	Connector for connection of anti-crash sensor (ENCODER)
SWC	SWC	Input, CLOSE limit switch (N.C. contact)
SWO	SWO	Input, OPEN limit switch (N.C. contact)
COM	COM (+12V)	Common for limit switches.
12-0-12	Secondary	Connection of secondary winding of 24V transformer
M1/COM/M2	Motor	Motor connection, 230Vac – single phase: M1-Phase/ COM-Common/ M2-Phase
CAP/CAP	Capacitor	Connection to capacitor
FLASH/FLASH	Flashing light	Connection to flashing light, 230Vac 40W max.
TRASF	Primary	Connection to transformer primary winding
The control unit is equipped with an built-in radio module for the reception of variable code controls, with ARC (Advanced Rolling-Code) or fixed code, 433.92 MHz frequency.		

### 12.2) FUSES

- F1** Protection fuse for motor and blinker  
**F2** Protection fuse of accessories and signals  
**F3** Protection of 230V/115V line

## 12.3) TO CHECK CONNECTIONS

Before programming the control unit, check that the motor is correctly connected:

- 1) Cut-off power supply.
- 2) Manually release the wing, move it to approx. half-stroke and lock it again.
- 3) Reset power supply.
- 4) Send a step-by-step control signal by pressing the button or the remote control key.
- 5) The door/gate should move in the opening phase. Conversely, use the MINV logics to invert the opening direction.
- 6) Cut-off and restore power supply.
- 7) Perform a complete operation, from limit switch to limit switch, without stops, to allow for the gate stroke memorisation.

## 13) STROKE LEARNING

For a correct operation of braking (with SLD logic: ON) it is essential that the stroke is memorised. This can be performed either using the above described AUTO function or when the first operation is completed (then carried out without interruptions) from open limit switch to close limit switch (or viceversa).

During the stroke learning the activation threshold values of the PMO and PMC anti-crash sensor and, if a slowing down is required, the PSO and PSC values, are also calculated.

However, these values can be manually modified at a second time.

If the encoder is activated, the position of the gate leaf is stored in memory and reset also in case of power failure.

If the encoder is disabled, in case of power failure a new complete operation will be required to memorise the stroke and reset braking.

Note: If the automatic system is released and manually operated, the following operation might not perform braking correctly. Also in this case a new complete operation will be required to reset the regular operation of the system.

## 14) ARC COMPATIBLE CONTROL UNIT

### IMPORTANT, PLEASE READ CAREFULLY:

The radio receiver in this product is compatible with the new ARC (Advanced Rolling Code) transmitters which, thanks to 128-bit encryption ensure superior copy-security.

Storing new ARC transmitters is quite similar to that of normal rolling code transmitters with HCS coding, but be aware that:

- 1) ARC transmitters and Rolling Code HCS can not be stored in a single receiver.
- 2) The first transmitter memorized determines the type of transmitters to be used later. If the first transmitter memorized is ARC, you can not store Rolling code HCS transmitters, and vice versa.
- 3) Fixed code transmitters may only be used in conjunction with Rolling code HCS transmitters, bringing the logic CVAR OFF. They are, therefore, not usable in combination with the ARC transmitters. If the first rolling code transmitter stored is an ARC CVAR the logic is inoperative.
- 4) If you want to change the type of transmitters it is necessary to proceed with a receiver reset.

## 15) OPERATING MODE WITH ENABLED/DISABLED ENCODER

### With ENC LOGICS =ON:

- the anti-crash sensor is activated. Adjust sensitivity through parameters SEAV and SEAR in compliance with regulations in force. An accurate adjustment of the motor brake (IBRA parameter) may help compliance with safety regulations as well.  
In the event of power failure, the stroke is constantly updated and stored in memory together with the gate position.

### With ENC LOGICS =OFF:

- the anti-crash sensor is disabled.  
- if parameter TSM>0 (braking activated), the first operation is performed at normal speed for the gate stroke memorisation, also in the event of power failure.

## 16) PROGRAMMING

The programming of the various functions of the control unit is carried out using the LCD display on the control unit and setting the desired values in the programming menus described below.

The parameters menu allows you to assign a numerical value to a function, in the same way as a regulating trimmer.

The logic menu allows you to activate or deactivate a function, in the same way as setting a dip-switch.

Other special functions follow the parameters and logic menus and may vary depending on the type of control unit or the software release.

### 16.1) USE OF PROGRAMMING KEYS

Press <PG> key to gain access to the Main Menu. These keys can be selected by pressing + and – keys.

- If <+> is pressed, the Function Menu can be scrolled from top to bottom.
- If <-> is pressed, the Function Menu can be scrolled from bottom to top.
- If <PG> key is pressed, presetting to be modified can be entered.
- The preset values can be modified by using <+> and <-> keys.
- The value is programmed if <PG> key is pressed again. The word “PRG” appears on the display.

See paragraph “Programming Example”.

### NOTES:

Simultaneously pressing <+> and <-> from inside a function menu allows you to return to the previous menu without making any changes.

If the push-button <-> is pressed with display off, this is like giving a step-by-step control.

When the board is switched on, the software version is displayed for around 5 sec

Hold down the <+> key or the <-> key to accelerate the increase/decrease of the values.

After waiting 30s the control unit quits programming mode and switches off the display.

## 17) PARAMETERS, LOGICS AND SPECIAL FUNCTIONS

In the tables hereunder the single functions available in the control unit are shown.

17.1) PARAMETERS (PAr)			
MENU	FUNCTION	MIN-MAX (Default)	MEMO
tAR	Automatic closure time. It is activated only with "tAR"=ON logic. At the end of the preset time, the control unit controls a closure operation.	3-240-(40s)	
tA	Operating time. The operating time is adjusted at normal speed during motor opening and closing phases.	1-250-(90s)	
tPEd	The area covered by the gate during its partial opening movement (pedestrian) is adjusted.	50-100-(15%)	
tSn	The area covered by the gate during the braking phase is adjusted. 0 = braking disabled	0-100-(10%)	
PNo	The torque applied to the motor in the opening phase is adjusted.*	1-99-(40%)	
Pnc	The torque applied to the motor in the closing phase is adjusted*.	1-99-(40%)	
PSo	The torque applied to the motor during braking in the closing phase is adjusted.*	1-99-(50%)	
PSc	The torque applied to the motor during braking in the opening phase is adjusted *	1-99-(50%)	
SEAU	The intervention threshold of the anti-crashing device (Encoder) during the phase at normal speed is adjusted.* 99:maximum sensitivity - 0: minimum sensitivity	0-99-(1%)	
SEAr	The intervention threshold of the anti-crashing device (Encoder) during braking is adjusted*. 99:maximum sensitivity - 0: minimum sensitivity	0-99-(1%)	
tLS	Activated only with SErL:ON Logic. The activation time of the service light is adjusted.	1-240-(60s)	
ibrA	The force of the motor brake is adjusted. 0: disabled braking - 1:minimum braking - 99: maximum braking	0-99-(50%)	
bLc	Adjusts the stoppage time after closure and opening limit switch interception. Function only active with slowing enabled (TSM>0). Value expressed in tenths of a second.	0-25-(0)	

\* **WARNING: An incorrect setting of these parameters may cause danger. Please comply with regulations in force!**

17.2) LOGIC (LoG)			
MENU	FUNCTION	ON-OFF-(Default)	MEMO
tAR	The automatic closure is enabled or disabled On: enabled automatic closure Off: disabled automatic closure	(ON)	
ibl	The multi-flat function is enabled or disabled. On: enabled multi-flat function. The P.P. (Step-by-step) impulse or the impulse of the transmitter have no effect in the opening phase. Off: disabled multi-flat function.	(OFF)	
ibcA	During the TCA phase, the PP and PED controls are enabled or disabled. When activated the logic function OPCL must be OFF. On: PP and PED controls are disabled. Off: PP and PED controls are enabled.	(OFF)	
SCL	The rapid closure is enabled or disabled On: rapid closure is enabled. When the gate is open or moving, the photocell activation causes the automatic closure of the gate after 3 s. It is activated only with TCA:ON Off: rapid closure is disabled.	(OFF)	
PP	The operating mode of "P.P. Push button" and of the transmitter are selected. On: Operation: OPEN > CLOSE > OPEN > Off: Operation: OPEN > STOP > CLOSE > STOP >	(OFF)	
PrE	Forewarning flashing light enabled or disabled. On: enabled forewarning flashing light. The flashing light is activated 3 s before the starting of the motor. Off: disabled forewarning flashing light.	(OFF)	
LtAR	During the TCA time, the blinker is enabled or disabled. On: Activated blinker. Off: De-activated blinker.	(OFF)	
htr	Enables or disables the hold to run function. OPCL must be ON. On: hold to run function enabled. During operation, the OPEN/CLOSE push-buttons must be kept pressed for all the stroke. Off: Automatic functioning.	(OFF)	
Enc	The Encoder is enabled or disabled. On: Encoder enabled. Off: Encoder disabled.	(ON)	



<b>cuAr</b>	Enables or disables the programmable code transmitters. IMPORTANT: The transmitters with programmable code can only be used in conjunction with the Rolling Code HCS transmitters. On: Radio receiver enabled only for transmitters Rolling Code (ARC or HCS, the first transmitter sets the operating mode). Off: Receiver enabled for transmitters Rolling Code HCS and programmable (self-learning and dip/switch).	(ON)	
<b>2ch</b>	The second radio channel is enabled or disabled on terminal AUX. On: AUX output, preset as second radio channel. SERL, TST1 and TST2 logics must be preset on OFF. Off: AUX output can be set as SCA, or by SERL, TST1 and TST2 logics.	(OFF)	
<b>SerL</b>	The service light function is enabled or disabled on AUX output. On: At each operation the contact is closed for the time preset with TLS parameter. TST1 and TST2 logics must be set on OFF. For the light control, use an auxiliary relay. Off: AUX output can be preset as SCA, or by 2CH, TST1 and TST2 logics.	(OFF)	
<b>tSt1</b>	Check of photocells on PHOT O input is enabled or disabled. On: check is enabled. If check is not successful, no operation is enabled. Off: AUX output can be preset as SCA, or by 2CH, SERL and TST2 logics.	(OFF)	
<b>tSt2</b>	Check of photocells on PHOT C input is enabled or disabled. On: check is enabled. If check is not successful, no operation is enabled. Off: AUX output can be preset as SCA, or by 2CH, SERL and TST1 logics.	(OFF)	
<b>PhcL</b>	The operating mode of the PHOT C input is selected. On: PHOT C input is activated in both opening and closing phases. In the opening phase: the contact opening causes the motor stop. When the photocell is released, the motor restarts in the opening phase. In closing phase: the contact opening causes the motor stop. When the photocell is released, the motor inverts the movement direction (open). Off: The PHOT C input is activated in the closing phase only. In the closing phase: the contact opening causes the motor stop and the immediate reversion of the operation direction (open).	(OFF)	
<b>oPcL</b>	PP input as OPEN and PED input as CLOSED are enabled or disabled. On: PP input is enabled as OPEN and PED input is enabled as CLOSE. Off: PP and PED inputs are enabled with their function.	(OFF)	
<b>SPn</b>	Enables or disables starting torque function. On: Starting torque enabled. At the start of each manoeuvre for 2s the motor operates at maximum torque. Off: Starting is performed at reduced speed for 2s and then movement is restored to normal speed.	(ON)	
<b>nInu</b>	The opening direction of the motor is selected (see Fig. 4): On: Right side motor mount Off: Left side motor mount	(OFF)	
<b>bAr</b>	Changing the operating mode of the PHOT OPEN and BAR inputs in the event the sensitive edges are installed on the mobile opening and closure edges (see Fig.5). On: The PHOT OPEN input assumes a similar function to the BAR input, but inverts motion for 3s only during the opening phase. The edge connected to the BAR input is only active during the closure phase. Off: Intervention of the sensitive edge connected to the BAR input stops movement of the door and inverts for approx. 3s, both opening and closure. The PHOT OPEN input re-starts functioning of the photocell active on opening.	(OFF)	
<b>rEn</b>	The remote storage of the radio transmitter codes is enabled or disabled (see par. REMOTE LEARNING). On: Enabled remote storage Off: Disabled remote storage.	(ON)	

### 17.3) RADIO (rAd)

MENU	FUNCTION
<b>pp</b>	By selecting this function, the receiver is waiting for (Push) a transmitter code to be assigned to the step-by-step function. Press the transmitter key, which is to be assigned to this function. If the code is valid, it will be stored in memory and OK will be displayed. If the code is not valid, the Err message will be displayed.
<b>2ch</b>	By selecting this function, the receiver is waiting for (Push) a transmitter code to be assigned to the second radio channel. Press the transmitter key, which is to be assigned to this function. If the code is valid, it will be stored in memory and OK will be displayed. If the code is not valid, the Err message will be displayed.
<b>PEd</b>	When this function is selected, the receiver awaits (Push) a transmitter code to be assigned to the pedestrian opening function (see TPED parameter). Press the transmitter key, which is to be assigned to this function. If the code is valid, it will be stored in memory and OK will be displayed. If the code is not valid, the Err message will be displayed.
<b>clr</b>	By selecting this function, the receiver is waiting for (Push) a transmitter code to be erased from memory. If the code is valid, it will be stored in memory and OK will be displayed. If the code is not valid, the Err message will be displayed.
<b>rtr</b>	The memory of the receiver is entirely erased. Confirmation for the operation is asked. By selecting this function, the receiver waits for (Push) the GPM key to be pressed again to confirm the operation. At end of erasing, the OK message is displayed

Note: The transmitters are stored in an EPROM memory (Fig.1 -U5), which can be removed and repositioned in a new control unit, if required.

## 17.4) CYCLES NUMBER (цикла)

Displays the number of complete cycles (open+close) carried out by the automation. When the <PG> button is pressed for the first time, it displays the first 4 figures, the second time it shows the last 4. Example <PG> 00 12 >>> <PG> 3456: made 123.456 cycles.

## 17.5) MAINTENANCE CYCLES (обслуж.)

This function enables to activate the maintenance request notice after a number of manoeuvres determined by the installer.

To activate and select the number of manoeuvres, proceed as follows:

Press button <PG>, the display will show OFF, which indicated that the function is disabled (default value).

With the buttons <+> and <-> select one of the numeric values proposed (from OFF to 100). The values are intended as hundreds of cycles of manoeuvres (for example: the value 50 indicates 5000 manoeuvres).

Press the OK button to activate the function. The display will show the message *Prac.* The maintenance request is indicated to the user by keeping the indicator lamp lit up for other 10 sec after the conclusion of the opening or closing operation.

## 17.6) RESET (сброс)

RESET of the control unit. ATTENTION!: Returns the control unit to the default values.

Pressing the <PG> button for the first time causes blinking of the letters *рЕ5*, pressing the <PG> button again resets the control unit. Note: The transmitters are not erased from the receiver nor is the access password.

All the logics and all the parameters are brought back to default values, it is therefore necessary to repeat the autosect procedure.

## 17.7) AUTOSET (авто)

The self-calibration of the triggering thresholds of the anti-crash device, as well as the stroke learning are performed.

When the <PG> push button is pressed once, the PUSH wording starts flashing. If the <PG> button is pressed once more the self-calibration procedure starts and the PRG wording is displayed. The gate will carry out at least 2 complete operations. At the end of this procedure, OK is displayed. This procedure can be performed with the gate in any position. The self-calibration procedure can be stopped at any moment with the contemporary pressure of <+> and <->. If the procedure has no positive result (or if ENC=OFF), the Err message is displayed.

## 17.8) PROTECTION CODE (код)

It allows to type in an access protection code to the programming of the control unit.

A four-character alphanumeric code can be typed in by using the numbers from 0 to 9 and the letters A-B-C-D-E-F.

The default value is 0000 (four zeros) and shows the absence of a protection code.

While typing in the code, this operation can be cancelled at any moment by pressing keys + and - simultaneously. Once the password is typed in, it is possible to act on the control unit by entering and exiting the programming mode for around 10 minutes in order to allow adjustments and tests on functions. By replacing the 0000 code with any other code, the protection of the control unit is enabled, thus preventing the access to any other menu. If a protection code is to be typed in, proceed as follows:

- select the Code menu and press OK.
- the code 0000 is shown, also in the case a protection code has been previously typed in.
- the value of the flashing character can be changed with keys + and -.
- press OK to confirm the flashing character, then confirm the following one.
- after typing in the 4 characters, a confirmation message "CONF" appears.
- after a few seconds, the code 0000 appears again
- the previously stored protection code must be reconfirmed in order to avoid any accidental typing in.

If the code corresponds to the previous one, a confirmation message "oH" appears.

The control unit automatically exits the programming phase. To gain access to the Menus again, the stored protection code must be typed in.

**IMPORTANT: TAKE NOTE of the protection code and KEEP IT IN A SAFE PLACE for future maintenance operations.**

**To remove a code from a protected control unit it is necessary to enter into programming with the password and bring the code back to the 0000 default value. IF YOU LOOSE THE CODE, PLEASE CONTACT THE AUTHORISED SERVICE CENTER FOR THE TOTAL RESET OF THE CONTROL UNIT.**

## 18) DIAGNOSTICS

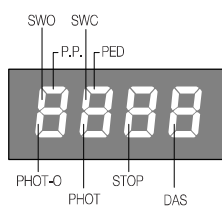

In the event of malfunctions, by pressing key + or - the status of all inputs (limit switches, control and safety) can be displayed. One segment of the display is linked to each input. In the event of failure it switches on according to the following scheme.

N.C. inputs are represented by the vertical segments. N.O. inputs are represented by the horizontal segments.

## 19) REMOTE COPY OF TRANSMITTER CODES

If a transmitter code is already stored in the receiver, the radio remote copy can be carried out (without accessing to the control unit).

**IMPORTANT:** This procedure should be performed with gate leaves open, during the TCA dwell time. Proceed as follows:

- 1 Press the hidden key of the already memorised transmitter.
- 2 Within 5 seconds, press the key of the already memorised transmitter which corresponds to the channel to be matched with the new transmitter code. The flashing light switches on.
- 3 Within 10 sec, press the hidden key of the new transmitter.
- 4 Within 5 sec, press the key of the new transmitter to be matched to the channel selected at point 2. The flashing light switches off.
- 5 The receiver memorises the new transmitter and exits immediately the programming mode.

## 20) ERROR MESSAGES

The control unit checks the correct operation of the safety devices. In the event of faults the following messages can be displayed:

<i>Err 1</i>	Motor	Technical assistance is required.
<i>Err 4</i>	Error, PHOT O circuit check	Check connections, alignment of PHOT O photocell or obstacle present.
<i>Err 5</i>	Error, PHOT C circuit check	Check connections, alignment of PHOT C photocell or obstacle present.
<i>Enc</i>	Error, encoder	Error to connection or faulty encoder.
<i>ANP</i>	Obstacle detection	An obstacle present is indicated (anti-crash device).

### SAFETY MEASURES

- Do not stand within the gate movement area.
- Children must not play with controls and near the gate.
- In the event of malfunctions, do not attempt to repair the failure but contact the specialised personnel.

### MANUAL AND EMERGENCY MANOEUVRE

In the event of power failure or malfunction, to manually operate the gate proceed as follows:

- After inserting the customized key C, turn it anti-clockwise and pull the lever L.
- The geared motor is unlocked and the gate can be moved by hand.
- To return to the normal operating mode, close the lever L again and manually activate the gate until it is geared.

### MAINTENANCE

- Every month check the good operation of the emergency manual release.
- It is mandatory not to carry out extraordinary maintenance or repairs as accidents may be caused. These operations must be carried out by qualified personnel only.
- The operator is maintenance free but it is necessary to check periodically if the safety devices and the other components of the automation system work properly. Wear and tear of some components could cause dangers.

### WASTE DISPOSAL



As indicated by the symbol shown, it is forbidden to dispose this product as normal urban waste as some parts might be harmful for environment and human health, if they are disposed of incorrectly. Therefore, the device should be disposed in special collection platforms or given back to the reseller if a new and similar device is purchased. An incorrect disposal of the device will result in fines applied to the user, as provided for by regulations in force.

### WARNING

All Benincá products are covered by insurance policy for any possible damages to objects and persons caused by construction faults under condition that the entire system be marked CE and only Benincá parts be used.

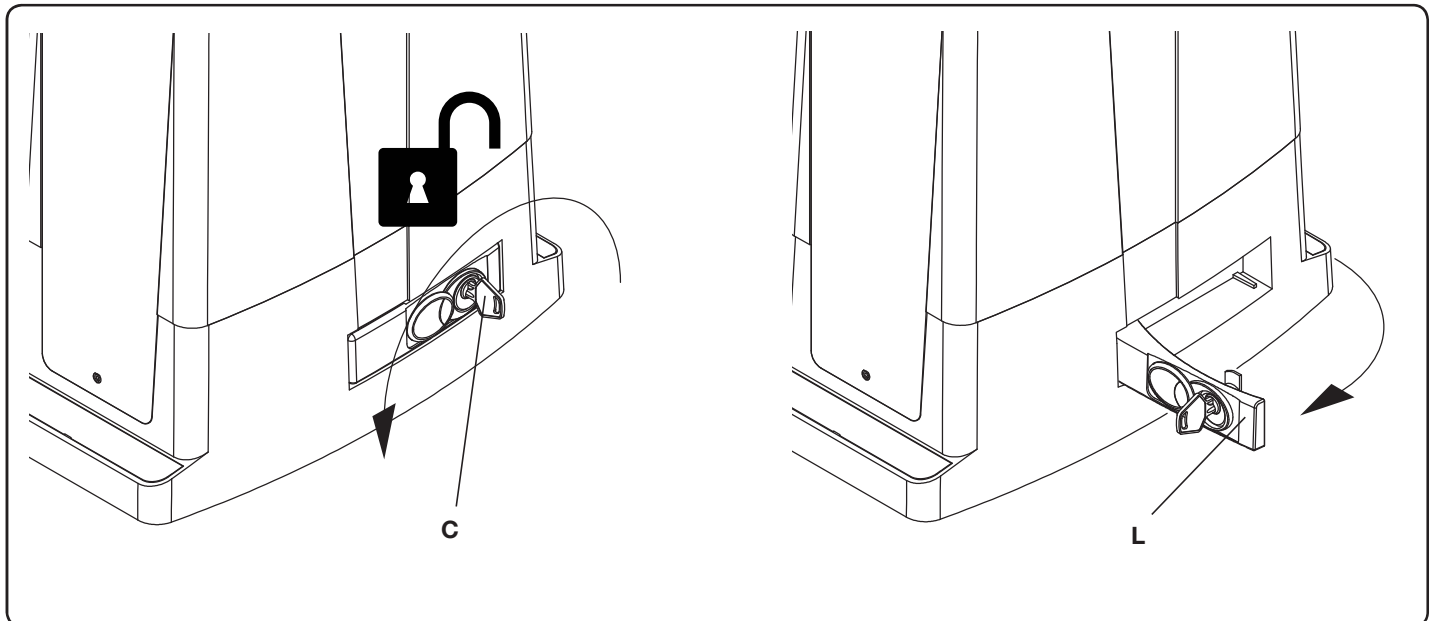



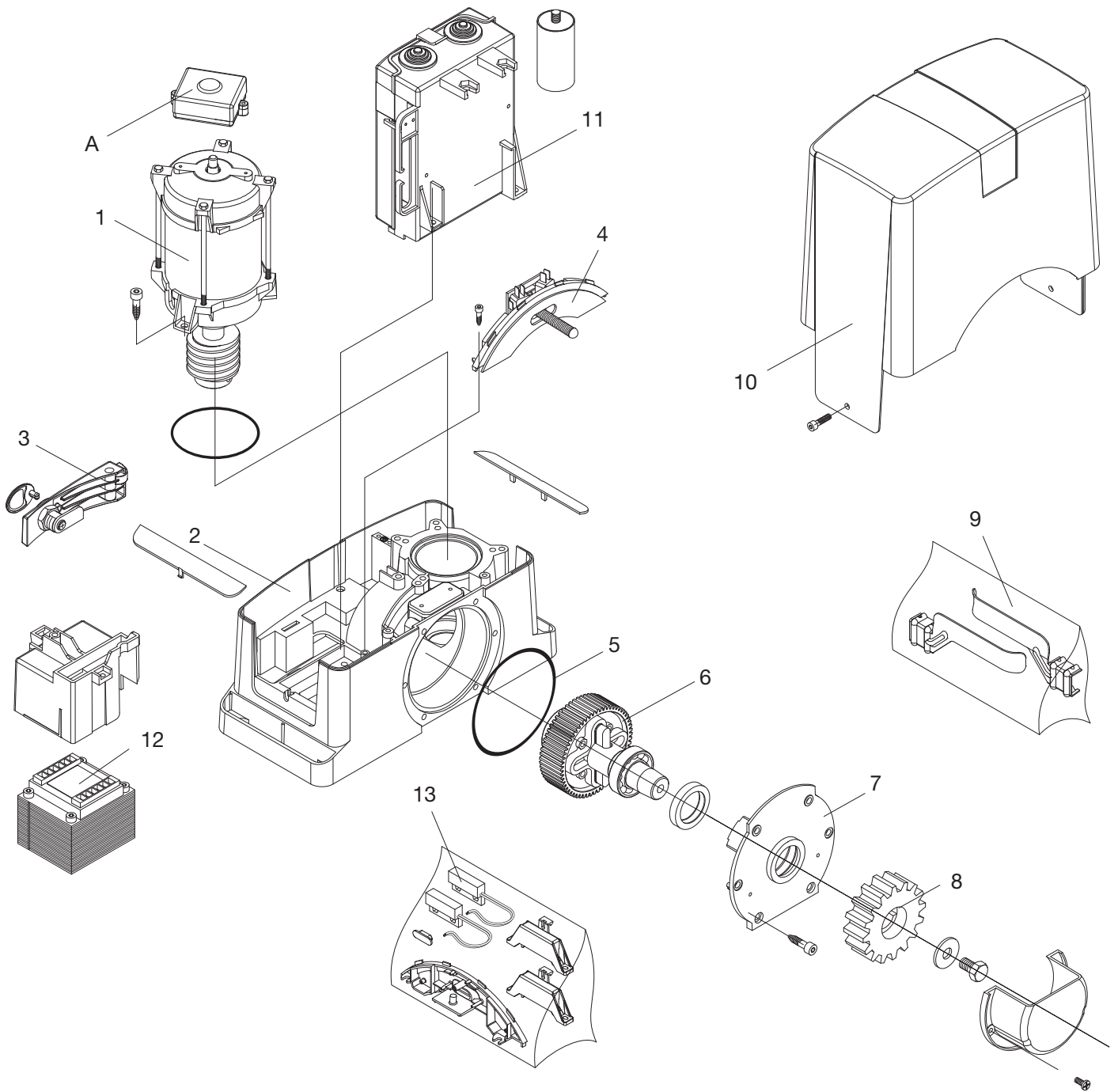

Ref.	BULL 5M Code	BULL 50M Code	Note
A	9760021	9760021	MAG.E
1	9686702	9688216	
2	9686770	9686770	
3	9686328	9686328	
4	9686329	9686329	
5	9686421	9686421	
6	9686703	9686511	
7	9686424	9686424	
8	9686032	9686032	
9	9686757	9686757	
10	9686427	9686427	
11	9686704	9686704	
12	9686449	9686449	
13	9688102	9688102	BULL __.S

## Dichiarazione di Conformità UE (DoC)

Nome del produttore: **Automatismi Benincà SpA**  
Indirizzo: **Via Capitello, 45 - 36066 Sandrigo (VI) - Italia**  
Telefono: **+39 0444 751030**  
Indirizzo e-mail: **sales@beninca.it**  
Persona autorizzata a costruire la documentazione tecnica:  
**Automatismi Benincà SpA**  
Tipo di prodotto: **Attuatori elettromeccanico 230Vac per cancelli scorrevoli** Modello/Tipo: **BULL5M/SOM**  
Accessori: **N/A**

Il sottoscritto Luigi Benincà, in qualità di Responsabile Legale, dichiara sotto la propria responsabilità che il prodotto sopraindicato risulta conforme alle disposizioni imposte dalle seguenti direttive:

**Direttiva 2014/30/UE** del Parlamento europeo e del Consiglio, del 26 febbraio 2014, concernente l'armonizzazione delle legislazioni degli Stati membri relative alla compatibilità elettromagnetica (**EMCD**), secondo le seguenti norme armonizzate:

EN 61000-6-2:2005, EN 61000-6-3:2007.

**Direttiva 2014/35/EU** DEL PARLAMENTO EUROPEO E DEL CONSIGLIO del 26 febbraio 2014 concernente l'armonizzazione delle legislazioni degli Stati membri relative alla messa a disposizione sul mercato del materiale elettrico destinato ad essere adoperato entro taluni limiti di tensione (**LVD**), secondo le seguenti norme armonizzate:

EN 60335-1:2012 + A11:2014; EN 60335-2-103:2015.

**Direttiva 2011/65/UE** del Parlamento europeo e del Consiglio, dell' 8 giugno 2011, sulla restrizione dell'uso di determinate sostanze pericolose nelle apparecchiature elettriche ed elettroniche (**RoHS**), secondo le seguenti norme armonizzate:

EN 50581:2012

**Direttiva 1999/5/CE** del Parlamento europeo e del Consiglio, del 9 marzo 1999, riguardante le apparecchiature radio e le apparecchiature terminali di telecomunicazione e il reciproco riconoscimento della loro conformità (R&TTE), secondo le seguenti norme armonizzate:

ETSI EN 301 489-3 V1.4.1 (2002) + ETSI EN 301 489-1 V1.4.1 (2002) +

ETSI EN 300 220-3 V1.1.1 (2000) + EN 60950-1 (2001)

**Direttiva 2006/42/CE** DEL PARLAMENTO EUROPEO E DEL CONSIGLIO del 17 maggio 2006 relativa alle macchine e che modifica la direttiva 95/16/CE, rispettando i requisiti per le "quasi macchine", secondo la seguente norma: EN13241-1:2003.

• Il produttore dichiara, inoltre, che la documentazione tecnica pertinente è stata compilata in conformità all'allegato VII B della direttiva 2006/42/CE e che sono stati rispettati i seguenti requisiti essenziali:

1.1.1 - 1.1.2 - 1.1.3 - 1.1.5 - 1.2.1 - 1.2.3 - 1.2.6 - 1.3.1 - 1.3.2 - 1.3.3 - 1.3.4 - 1.3.7 - 1.3.9 - 1.5.1 - 1.5.2 - 1.5.4 - 1.5.5 - 1.5.6 - 1.5.7 - 1.5.8 - 1.5.10 - 1.5.11 - 1.5.13 - 1.6.1 - 1.6.2 - 1.6.4 - 1.7.2 - 1.7.4 - 1.7.4.1 - 1.7.4.2 - 1.7.4.3.

• Il produttore si impegna a trasmettere alle autorità nazionali, in risposta ad una motivata richiesta, le informazioni pertinenti sulla "quasi macchina". L'impegno comprende le modalità di trasmissione e lascia impregiudicati i diritti di proprietà intellettuale del fabbricante della "quasi macchina".

• Si comunica che la "quasi macchina" non deve essere messa in servizio finché la macchina finale in cui deve essere incorporata non è stata dichiarata conforme, se del caso, alle disposizioni della direttiva 2006/42/CE.

• Inoltre il prodotto, limitatamente alle parti applicabili, risulta conforme alle seguenti norme:

EN 12445:2002, EN 12453:2002, EN 12978:2003.

Benincà Luigi, Responsabile legale.  
Sandrigo, 05/10/2016.

Il Certificato di Conformità di questo documento corrisponde all'ultima revisione disponibile al momento della stampa e può risultare differente per esigenze editoriali dall'originale disponibile presso il produttore.

Il Certificato di Conformità più completo e recente è disponibile consultando il sito: [www.beninca.com](http://www.beninca.com) oppure può essere richiesto presso:  
Automatismi Benincà S.p.A - Sandrigo VI - Italy.

## UE Declaration of Conformity (DoC)

Manufacturer's name: **Automatismi Benincà SpA**  
Address: **Via Capitello, 45 - 36066 Sandrigo (VI) - Italia**  
Telephone: **+39 0444 751030**  
Email address: **sales@beninca.it**  
Person authorised to draft the technical documentation:  
**Automatismi Benincà SpA**  
Product type: **automatic system 230Vac for sliding gates**  
Model/type: **BULL5M/SOM**  
Accessories: **N/A**

The undersigned Luigi Benincà, as the Legal Officer, declares under his liability that the aforementioned product complies with the provisions established by the following directives:

**Directive 2014/30/UE** OF THE EUROPEAN PARLIAMENT AND OF THE COUNCIL of 26 February 2014, on the harmonisation of the laws of Member States relating to electromagnetic compatibility, according to the following harmonised regulations:

EN 61000-6-2:2005, EN 61000-6-3:2007 + A1:2011.

**Directive 2014/35/UE** OF THE EUROPEAN PARLIAMENT AND OF THE COUNCIL of 26 February 2014, on the harmonisation of the laws of Member States relating to electrical equipment designed for use with certain voltage limits, according to the following harmonised regulations:

EN 60335-1:2012 + A11:2014; EN 60335-2-103:2015.

**Directive 2011/65/EU** of the European Parliament and Council, dated 8 June 2011, on the restricted use of certain hazardous substances in electrical and electronic devices (**RoHS**), according to the following standards:

EN 50581:2012

**Directive 1999/5/CE** OF THE EUROPEAN PARLIAMENT AND COUNCIL,

9 March 1999 in relation to radio equipment and telecommunications terminals and the mutual recognition of their conformity, per the following harmonised standards:

ETSI EN 301 489-3 V1.4.1 (2002) + ETSI EN 301 489-1 V1.4.1 (2002) +

ETSI EN 300 220-3 V1.1.1 (2000) + EN 60950-1 (2001)

**Directive 2006/42/EC** OF THE EUROPEAN PARLIAMENT AND OF THE COUNCIL of 17 May 2006, on machinery, which amends Directive 95/16/EC, and complies with the requisites for the "partly completed machinery (almost machinery)" set forth in the EN13241-1:2003 regulation.

• The manufacturer declares that the pertaining technical documentation has been drawn up in compliance with Attachment VII B of the 2006/42/ EC Directive and that the following requirements have been complied with:

1.1.1 - 1.1.2 - 1.1.3 - 1.1.5 - 1.2.1 - 1.2.3 - 1.2.6 - 1.3.1 - 1.3.2 - 1.3.3 - 1.3.4 - 1.3.7 - 1.3.9 - 1.5.1 - 1.5.2 - 1.5.4 - 1.5.5 - 1.5.6 - 1.5.7 - 1.5.8 - 1.5.10 - 1.5.11 - 1.5.13 - 1.6.1 - 1.6.2 - 1.6.4 - 1.7.2 - 1.7.4 - 1.7.4.1 - 1.7.4.2 - 1.7.4.3.

• The manufacturer undertakes that information on the "partly completed machinery" will be sent to domestic authorities. Transmission ways are also included in the undertaking, and the Manufacturer's intellectual property rights of the "almost machinery" are respected.

• It is highlighted that commissioning of the "partly completed machinery" shall not be provided until the final machinery, in which it should be incorporated, is declared compliant, if applicable, with provisions set forth in the Directive 2006/42/EC on Machinery.

• Moreover, the product, as applicable, is compliant with the following regulations:

EN 12445:2002, EN 12453:2002, EN 12978:2003

Benincà Luigi, Legal Officer.  
Sandrigo, 05/10/2016.

The certificate of conformity in this document corresponds to the last review available at the time of printing and could differ for editorial requirements from the original available from the manufacturer.

The most recent and complete certificate of conformity is available consulting the site: [www.beninca.com](http://www.beninca.com) or can be requested from:  
Automatismi Benincà SpA - Sandrigo VI - ITALY.

## EG-Konformitätserklärung (DoC)

Name des Herstellers: **Automatismi Benincà SpA**  
Adresse: **Via Capitello, 45 - 36066 Sandrigo (VI) - Italia**  
Telefon: **+39 0444 751030**  
E-Mail-Adresse: **sales@beninca.it**  
Zur Erstellung der technischen Dokumentation berechnigte Person: **Automatismi Benincà SpA**  
Produkttypus: **Automation für Schiebetore**  
Modell/Typus: **BULL5M/SOM** Zubehör: **N/A**

Der Unterzeichnete Luigi Benincà, in seiner Eigenschaft als Rechtsvertreter, erklärt eigenverantwortlich, dass das oben angegebene Produkt den durch die folgenden Richtlinien vorgegebene Bestimmungen entspricht:

**Richtlinie 2014/30/UE** DES EUROPÄISCHEN PARLAMENTES UND DES RATES vom 26. Februar 2014 zur Angleichung der Rechtsvorschriften der Mitgliedstaaten über die elektromagnetische Verträglichkeit, gemäß nachstehenden Normen:

EN 61000-6-2:2005, EN 61000-6-3:2007 + A1:2011.

**Richtlinie 2014/35/UE** DES EUROPÄISCHEN PARLAMENTES UND DES RATES vom 26. Februar 2014 zur Angleichung der Rechtsvorschriften der Mitgliedstaaten betreffend elektrische Betriebsmittel zur Verwendung innerhalb bestimmter Spannungsgrenzen, gemäß nachstehenden Normen:

EN 60335-1:2012 + A11:2014; EN 60335-2-103:2015.

**Richtlinie 2011/65/EU** des Europäischen Parlaments und des Rates vom 8. Juni 2011 zur Beschränkung der Verwendung bestimmter gefährlicher Stoffe in Elektro- und Elektronikgeräten (**RoHS**), gemäß den folgenden harmonisierten Normen:

EN 50581:2012

**Richtlinie 1999/5/CE** DES EUROPÄISCHEN PARLAMENTES UND EUROPARATS vom 9. März 1999 in Bezug auf Funkapparate und Telekommunikations-Endgeräte und die gegenseitige Anerkennung ihrer Konformität entsprechend den folgenden harmonisierten Normen:

ETSI EN 301 489-3 V1.4.1 (2002) + ETSI EN 301 489-1 V1.4.1 (2002) +

ETSI EN 300 220-3 V1.1.1 (2000) + EN 60950-1 (2001)

**Richtlinie 2006/42/EG** DES EUROPÄISCHEN PARLAMENTES UND DES RATES vom 17. Mai 2006 über Maschinen, zur Aufhebung der Richtlinie 95/16/EG, gemäß Anforderungen für „unvollständige Maschinen“ und nachstehender Norm:

EN13241-1:2003.

• Der Hersteller erklärt, dass die technischen Unterlagen gemäß Anhang VII Teil B der Richtlinie 2006/42/EG erstellt wurden und dass das Produkt folgenden Anforderungen entspricht:

1.1.1 - 1.1.2 - 1.1.3 - 1.1.5 - 1.2.1 - 1.2.3 - 1.2.6 - 1.3.1 - 1.3.2 - 1.3.3 - 1.3.4 - 1.3.7 - 1.3.9 - 1.5.1 - 1.5.2 - 1.5.4 - 1.5.5 - 1.5.6 - 1.5.7 - 1.5.8 - 1.5.10 - 1.5.11 - 1.5.13 - 1.6.1 - 1.6.2 - 1.6.4 - 1.7.2 - 1.7.4 - 1.7.4.1 - 1.7.4.2 - 1.7.4.3.

• Der Hersteller verpflichtet sich die Informationen zu der „unvollständigen Maschine“ einzelstaatlichen Stellen auf begründetes Verlangen zu übermitteln. Durch die Übermittlung bleibt das intellektuelle Eigentum des Herstellers der „unvollständigen Maschine“ unberührt.

• Diese „unvollständige Maschine“ darf erst dann in Betrieb genommen werden, wenn gegebenenfalls festgestellt wurde, dass die Maschine, in die die unvollständige Maschine eingebaut werden soll, den Bestimmungen der Maschinenrichtlinie 2006/42/EG entspricht.

• Das Produkt entspricht außerdem, falls zutreffend, folgenden Normen:

EN 12445:2002, EN 12453:2002, EN 12978:2003.

Benincà Luigi, Rechtsvertreter.  
Sandrigo, 05/10/2016.

Die in diesem Dokument vorliegende Konformitätserklärung entspricht der neuesten zum Druckzeitpunkt erhältlichen Revision und könnte aufgrund von verlegerischen Gründen vom beim Hersteller erhältlichen Original abweichen.

Die neueste und vollständigste Konformitätserklärung ist auf der Internetseite: [www.beninca.com](http://www.beninca.com) erhältlich oder kann bei folgender Adresse angefordert werden: Automatismi Benincà SpA - Sandrigo VI - ITALY.

## Déclaration CE de conformité (DoC)

Nom du producteur : **Automatismi Benincà SpA**  
Adresse : **Via Capitello, 45 - 36066 Sandrigo (VI) - Italia**  
Téléphone : **+39 0444 751030**  
Adresse e-mail : **sales@beninca.it**  
Personne autorisée à construire la documentation technique :  
**Automatismi Benincà SpA**  
Type de produit : **automatismes pour portails coulissant modèle**  
Modèle/Type : **BULL5M/50M Accessoires : N/A**

Le soussigné Luigi Benincà, en sa qualité de Représentant Légal, déclare sous sa propre responsabilité que le produit indiqué ci-dessus est conforme aux dispositions imposées par les directives suivantes:

**Directive 2014/30/UE DU PARLEMENT EUROPÉEN ET DU CONSEIL** du 26 février 2014 concernant le rapprochement des législations des États membres relatives à la compatibilité électromagnétique, selon les suivantes normes harmonisées:

EN 61000-6-2:2005, EN 61000-6-3:2007 + A1:2011.

**Directive 2014/35/UE DU PARLEMENT EUROPÉEN ET DU CONSEIL** du 26 février 2014 concernant le rapprochement des législations des États membres relatives au matériel électrique destiné à être employé dans certaines limites de tension, selon les suivantes normes harmonisées:

EN 60335-1:2012 + A11:2014; EN 60335-2-103:2015.

**Directive 2011/65/UE** du Parlement européen et du Conseil, du 8 juin 2011, sur la restriction à l'usage de substances dangereuses déterminées dans les appareils électriques et électroniques (**RoHS**), selon les normes harmonisées suivantes :

EN 50581:2012

**Directive 1999/5/CE DU PARLEMENT EUROPÉEN ET DU CONSEIL** du 9 mars 1999 concernant les équipements radio et les terminaux de télécommunications et la reconnaissance réciproque de leur conformité, selon les normes harmonisées suivantes:

ETSI EN 301 489-3 V1.4.1 (2002) + ETSI EN 301 489-1 V1.4.1 (2002) +

ETSI EN 300 220-3 V1.1.1 (2000) + EN 60950-1 (2001)

**Directive 2006/42/CE DU PARLEMENT EUROPÉEN ET DU CONSEIL** du 17 mai 2006 concernant les machines et qui modifie la Directive 95/16/CE, en respectant les conditions requises pour les "quasi-machines", selon la norme suivante:

EN13241-1:2003.

• Le fabricant déclare, en outre, que la documentation technique pertinente a été constituée conformément à l'annexe VII B de la Directive 2006/42/CE et que les conditions requises essentielles ci de suite ont été respectées:

1.1.1 - 1.1.2 - 1.1.3 - 1.1.5 - 1.2.1 - 1.2.3 - 1.2.6 - 1.3.1 - 1.3.2 - 1.3.3 - 1.3.4 - 1.3.7 - 1.3.9 - 1.5.1 - 1.5.2 - 1.5.4 - 1.5.5 - 1.5.6 - 1.5.7 - 1.5.8 - 1.5.10 - 1.5.11 - 1.5.13 - 1.6.1 - 1.6.2 - 1.6.4 - 1.7.2 - 1.7.4 - 1.7.4.1 - 1.7.4.2 - 1.7.4.3.

• Le fabricant s'engage à transmettre aux autorités nationales, suite à une demande motivée, les informations concernant la "quasi-machine". Cet engagement comprend les modalités de transmission et reste sans préjudices pour les droits de propriété intellectuelle du fabricant sur la "quasi machine".

• On communique que la "quasi-machine" ne doit pas être mise en service avant que la machine finale, dans laquelle elle doit être incorporée, ait été elle-même déclarée conforme, le cas échéant, aux dispositions de la Directive 2006/42/CE.

• En outre le produit, exclusivement en ce qui concerne les parties applicables, résulte conforme aux normes suivantes:  
EN 12445:2002, EN 12453:2002, EN 12978:2003.

Benincà Luigi, Représentant Légal.  
Sandrigo, 05/10/2016.

Le certificat de conformité présent dans ce document correspond à la dernière révision disponible au moment de l'impression et pourrait différer pour des exigences éditoriales de l'original disponible chez le constructeur.

Le certificat de conformité le plus récent et complet est disponible en consultant le site : [www.beninca.com](http://www.beninca.com) ou peut être demandé à :

Automatismi Benincà SpA - Sandrigo VI - ITALIE.

## Declaración CE de conformidad (DoC)

Nombre del productor: **Automatismi Benincà SpA**  
Dirección: **Via Capitello, 45 - 36066 Sandrigo (VI) - Italia**  
Teléfono: **+39 0444 751030** Dirección de correo electrónico: **sales@beninca.it**  
Persona autorizada a producir la documentación técnica:  
**Automatismi Benincà SpA**  
Tipo de producto: **automatización para cancelas correderas**  
Modelo/Tipo: **BULL5M/50M Accesorios: N/A**

El infrascrito Luigi Benincà, en calidad de Representante Legal, declara bajo su responsabilidad que el producto anteriormente mencionado resulta en conformidad con las disposiciones establecidas por las siguientes directivas:

**Directiva 2014/30/UE** del parlamento europeo y del consejo del 26 de febrero de 2014 sobre la aproximación de las legislaciones de los Estados miembros con relación a la compatibilidad electromagnética, según las siguientes normas armonizadas:

EN 61000-6-2:2005, EN 61000-6-3:2007.

**Directiva 2014/35/UE DEL PARLAMENTO EUROPEO Y DEL CONSEJO** del 26 de febrero de 2014 sobre la aproximación de las legislaciones de los Estados miembros con relación al material eléctrico destinado a ser utilizado dentro de determinados límites de tensión, según las siguientes normas armonizadas:

EN 60335-1:2012 + A11:2014; EN 60335-2-103:2015.

**Directiva 2011/65/UE** del Parlamento europeo e del Consejo, de 8 de junio de 2011, sobre restricciones a la utilización de determinadas sustancias peligrosas en aparatos eléctricos y electrónicos (**RoHS**), según las normas siguientes armonizadas:

EN 50581:2012

**Directiva 1999/5/CE DEL PARLAMENTO EUROPEO Y DEL CONSEJO** del 9 de marzo de 1999 sobre los equipos de radio y terminales de telecomunicación y el recíproco reconocimiento de su conformidad según las siguientes normas armonizadas:

ETSI EN 301 489-3 V1.4.1 (2002) + ETSI EN 301 489-1 V1.4.1 (2002) +

ETSI EN 300 220-3 V1.1.1 (2000) + EN 60950-1 (2001)

**Directiva 2006/42/CE DEL PARLAMENTO EUROPEO Y DEL CONSEJO** del 17 de mayo de 2006 relativa a las máquinas y que modifica la Directiva 95/16/CE, respetando los requisitos para las "cuasi máquinas", conforme a la norma siguiente:

EN13241-1:2003.

• El fabricante declara así mismo que la documentación técnica pertinente ha sido redactada conforme al anexo VII B de la Directiva 2006/42/CE y que se han respetado los siguientes requisitos esenciales:

1.1.1 - 1.1.2 - 1.1.3 - 1.1.5 - 1.2.1 - 1.2.3 - 1.2.6 - 1.3.1 - 1.3.2 - 1.3.3 - 1.3.4 - 1.3.7 - 1.3.9 - 1.5.1 - 1.5.2 - 1.5.4 - 1.5.5 - 1.5.6 - 1.5.7 - 1.5.8 - 1.5.10 - 1.5.11 - 1.5.13 - 1.6.1 - 1.6.2 - 1.6.4 - 1.7.2 - 1.7.4 - 1.7.4.1 - 1.7.4.2 - 1.7.4.3.

• El fabricante se compromete a transmitir a las autoridades nacionales, contestando a una solicitud motivada, la información pertinente sobre la "cuasi máquina". El compromiso incluye las modalidades de transmisión y no afecta a los derechos de propiedad intelectual del fabricante de la "cuasi máquina".

• Se comunica que la "cuasi máquina" no se tiene que poner en servicio hasta que la máquina final, en la cual se tiene que incorporar, ha sido declarada conforme si aplicable, a las disposiciones de la Directiva 2006/42/CE.

• Además, el producto, limitadamente a las partes aplicables, resulta ser conforme a las siguientes normas:

EN 12445:2002, EN 12453:2002, EN 12978:2003.

Benincà Luigi, Representante Legal.  
Sandrigo, 05/10/2016.

El certificado de conformidad presente en este documento corresponde a la última revisión disponible en el momento de la impresión y podría diferir por exigencias editoriales del original disponible en la sede del fabricante.

El certificado de conformidad más reciente y completo está disponible consultando el sitio: [www.beninca.com](http://www.beninca.com) o se puede solicitar a: Automatismi Benincà SpA - Sandrigo VI - ITALY.

## Deklaracja zgodności CE (DoC)

Nazwa producenta: **Automatismi Benincà SpA**  
Adres: **Via Capitello, 45 - 36066 Sandrigo (VI) - Italia**  
Telefon: **+39 0444 751030** Adres e-mail: **sales@beninca.it**  
Osoba upoważniona do stworzenia dokumentacji technicznej:  
**Automatismi Benincà SpA**  
Rodzaj produktu: **urządzenie automatyzacji bram przesuwnych**  
Model/Typ: **BULL5M/50M Akcesoria: N/A**

Niżej podpisany/a Luigi Benincà, jako Przedstawiciel prawny, deklaruje na własną odpowiedzialność, że wskazany produkt jest zgodny z rozporządzeniami następujących dyrektyw:

**Dyrektywy 2014/30/WE** rady I parlamentu europejskiego z dnia 26 lutego 2014r. w sprawie zbliżania ustawodawstwa państw członkowskich w zakresie kompatybilności elektromagnetycznej, zgodnie z następującymi normami zharmonizowanymi:

EN 61000-6-2:2005, EN 61000-6-3:2007 + A1:2011.

**Dyrektywy 2014/35/WE RADY I PARLAMENTU EUROPEJSKIEGO** z dnia 26 lutego 2014r. w sprawie zbliżania ustawodawstwa państw członkowskich w zakresie bezpieczeństwa sprzętu elektrycznego o określonych granicach napięcia, zgodnie z następującymi normami zharmonizowanymi:

EN 60335-1:2012 + A11:2014; EN 60335-2-103:2015.

**Dyrektywa 2011/65/WE** Parlamentu Europejskiego i Rady z 8 czerwca 2011 r. w sprawie ograniczenia stosowania niektórych niebezpiecznych substancji w sprzęcie elektrycznym i elektronicznym (**RoHS**), zgodnie z poniższymi normami zharmonizowanymi:

EN 50581:2012

**Dyrektywa 1999/5/WE** Parlamentu Europejskiego i Rady z dnia 9 marca 1999 dotycząca urządzeń radiowych i końcowych urządzeń telekomunikacyjnych oraz wzajemnego uznawania ich zgodności, zgodnie z następującymi normami zharmonizowanymi.

ETSI EN 301 489-3 V1.4.1 (2002) + ETSI EN 301 489-1 V1.4.1

(2002) + ETSI EN 300 220-3 V1.1.1 (2000) + EN 60950-1 (2001)

**Dyrektywy 2006/42/WE PARLAMENTU I RADY EUROPEJSKIEJ** z dnia 17 maja 2006r. w sprawie maszyn zmieniającej dyrektywę 95/16/WE, z zachowaniem wymogów dotyczących "części maszyn", wg następującej normy:

EN13241-1:2003.

• Producent oświadcza, że stosowna dokumentacja techniczna została sporządzona na podstawie treści załącznika VII B do dyrektywy 2006/42/WE i że zostały spełnione następujące zasadnicze wymagania:

1.1.1 - 1.1.2 - 1.1.3 - 1.1.5 - 1.2.1 - 1.2.3 - 1.2.6 - 1.3.1 - 1.3.2 - 1.3.3 - 1.3.4 - 1.3.7 - 1.3.9 - 1.5.1 - 1.5.2 - 1.5.4 - 1.5.5 - 1.5.6 - 1.5.7 - 1.5.8 - 1.5.10 - 1.5.11 - 1.5.13 - 1.6.1 - 1.6.2 - 1.6.4 - 1.7.2 - 1.7.4 - 1.7.4.1 - 1.7.4.2 - 1.7.4.3.

• Producent zobowiązuje się do przesłania informacji dotyczących "części maszyny" na uzasadniony wniosek krajowego organu władzy. Zobowiązanie dotyczy trybu przesłania informacji i utrzymuje w mocy prawa własności intelektualnej producenta "części maszyny".

• Powiadamia się, że "część maszyny" nie powinna być oddana do eksploatacji do chwili, gdy końcowa maszyna, do której dana część ma być wbudowana nie otrzyma deklaracji zgodności z mającymi zastosowanie wymogami dyrektywy 2006/42/WE.

• Ponadto, w odniesieniu do części objętych postanowieniami, produkt spełnia wymagania następujących norm:

EN 12445:2002, EN 12453:2002, EN 12978:2003.

Benincà Luigi, Przedstawiciel prawny.  
Sandrigo, 05/10/2016.

Certyfikat zgodności znajdujący się w niniejszym dokumencie odpowiada ostatniej aktualizacji dostępnej w momencie wydruku i może się różnić ze względów wydawniczych od oryginału dostępnego u producenta.

Najbardziej aktualny i kompletny certyfikat zgodności jest dostępny na stronie: [www.beninca.com](http://www.beninca.com) lub można się po niego zwrócić do: Automatismi Benincà SpA - Sandrigo VI - WŁOCHY.

**BENINCA<sup>®</sup>**  
TECHNOLOGY TO OPEN

**AUTOMATISMI BENINCÀ SpA** - Via Capitello, 45 - 36066 Sandrigo (VI) ITALY - Tel. 0444 751030 r.a. - Fax 0444 759728  
[www.beninca.com](http://www.beninca.com) - [sales@beninca.it](mailto:sales@beninca.it)

---